

**GENERAL NOTES**

- 2005 TOPOGRAPHICAL SURVEY DATA WAS PROVIDED BY BALTIMORE COUNTY IN 2012.
- THE PROJECT CORRIDOR CROSSES RESIDENTIAL AND AGRICULTURAL LAND USES. SEVERAL CONSERVATION EASEMENTS ARE ALSO LOCATED WITHIN THE PROJECT CORRIDOR AND ARE ILLUSTRATED ON THE PLANS.
- CRITICAL HABITATS CONSIST OF NON-TIDAL WETLANDS, THEIR BUFFERS, STEEP SLOPES, AND WATERS OF THE U.S.
- NO RARE, THREATENED, OR ENDANGERED SPECIES WERE ENCOUNTERED DURING THE FIELD INVESTIGATIONS. CORRESPONDENCE WITH MARYLAND DEPARTMENT OF NATURAL RESOURCES INDICATES THAT BOG TURTLE HABITAT EXISTS IN SOME WATERSHEDS CROSSED BY THE PROJECT CORRIDOR. BOG TURTLE SURVEYS ARE COMPLETE, AND NO BOG TURTLE POPULATIONS WERE IDENTIFIED. COLUMBIA GAS TRANSMISSION, LLC RECEIVED BOG TURTLE CONCURRENCE FROM MDNR ON MAY 28, 2013.
- INITIAL CORRESPONDENCE WITH MARYLAND HISTORICAL TRUST INDICATED THAT THE BALTIMORE COUNTY PORTION OF THE PROJECT WILL NOT IMPACT SITES ELIGIBLE FOR LISTING IN THE NATIONAL REGISTER. A SUPPLEMENTAL CULTURAL RESOURCE REPORT FOR ALIGNMENT REVISIONS WAS SUBMITTED TO MARYLAND HISTORICAL TRUST ON JANUARY 15, 2013, AND THE AGENCY PROVIDED FINAL CLEARANCE FOR ALL PROJECT WORKSPACE ON MARCH 7, 2013.
- THIS FCP/FBPP ADDRESSES LINE MB PIPELINE EXTENSION PROJECT PHASE 1 THAT IS PROPOSED FOR CONSTRUCTION IN 2013. THIS PORTION IS FROM MILEPOST (MP) 15.8 TO THE HARFORD COUNTY LINE AT MP 17.7.

# FOREST CONSERVATION PLAN / FOREST BUFFER PROTECTION PLAN COLUMBIA GAS TRANSMISSION, LLC LINE MB PIPELINE EXTENSION PROJECT PHASE 1

**WATER RESOURCES NOTES**

- WATERS OF THE UNITED STATES (WUS) AND WETLANDS WERE DELINEATED BY CH2M HILL FROM DECEMBER 2011 THROUGH DECEMBER 2012 WITHIN A 200 - 300 FT SURVEY CORRIDOR. THE WETLAND DELINEATION SURVEY CORRIDOR VARIES FROM THE FOREST STAND CORRIDOR IN CERTAIN AREAS. SEE WETLAND AND WATERBODY DELINEATION REPORT SUBMITTED PREVIOUSLY UNDER SEPARATE COVER FOR MORE INFORMATION.
- FOUR NONTIDAL WETLANDS, ONE WUS, TWO EPHEMERAL CHANNELS, AND TWO PONDS WERE LOCATED WITHIN THE CONSTRUCTION WORK AREA ON THIS PORTION OF BALTIMORE COUNTY LANDS.
- NO STREAMS WILL BE DISTURBED IN THE CONSTRUCTION OF LINE MB PHASE 1. LITTLE GUNPOWDER FALLS WILL BE CROSSED USING THE HORIZONTAL DIRECTIONAL DRILL (HDD) METHOD.

**FOREST RESOURCES NOTES**

- THE STUDY AREA BOUNDARY IS A 250-FOOT TO 300-FOOT WIDE CORRIDOR.
- FOREST STANDS EXTEND BEYOND THE STUDY AREA BOUNDARY.
- FOURTEEN (14) FOREST STANDS WERE IDENTIFIED DURING FIELD INVESTIGATIONS IN THIS PORTION OF BALTIMORE COUNTY.
- SPECIMEN TREES HAVE BEEN MARKED WITH AN "X" FOR REMOVAL WHERE MORE THAN 33% OF THE SPECIMEN TREE'S CRITICAL ROOT ZONE IS IMPACTED.
- FOREST BUFFERS WERE CALCULATED AT 100 FEET FROM WATERS OF THE US (NOT INCLUDING EPHEMERAL CHANNELS), 100 FEET FROM WETLANDS, OR 25 FEET FROM THE 100-YEAR FLOODPLAIN, WHICHEVER DISTANCE WAS GREATER.
- FORESTED WETLANDS TO BE IMPACTED AND MITIGATED FOR THE STATE WERE SUBTRACTED FROM THE AREA OF FOREST CLEARING IN ACCORDANCE WITH SECTION 33-6-108 (e) (2) OF BALTIMORE COUNTY'S FOREST CONSERVATION LAW.
- FOREST CLEARING AND SPECIMEN TREE REMOVAL WITHIN PUBLIC ROAD RIGHTS-OF-WAY ARE ACCOUNTED FOR IN THE ROADSIDE TREE PERMIT, ISSUED BY MARYLAND DEPARTMENT OF NATURAL RESOURCES ON FEBRUARY 22, 2013, AND ARE NOT INCLUDED IN THIS FOREST CONSERVATION PLAN.
- IN PHASE 1, PROPOSED FOR 2013 CONSTRUCTION (MP 15.8 - 17.7), 0.07 ACRE OF TEMPORARY WORKSPACES WITHIN BALTIMORE COUNTY FOREST BUFFERS (FB) WILL BE REPLANTED AS MITIGATION FOR IMPACTS. AN ADDITIONAL 5.31 ACRES WILL BE MET VIA PURCHASE OF CREDITS IN A BALTIMORE COUNTY APPROVED FOREST/FOREST BUFFER PLANTING BANK AND/OR PURCHASE OF A FEE-IN-LIEU TO BALTIMORE COUNTY.

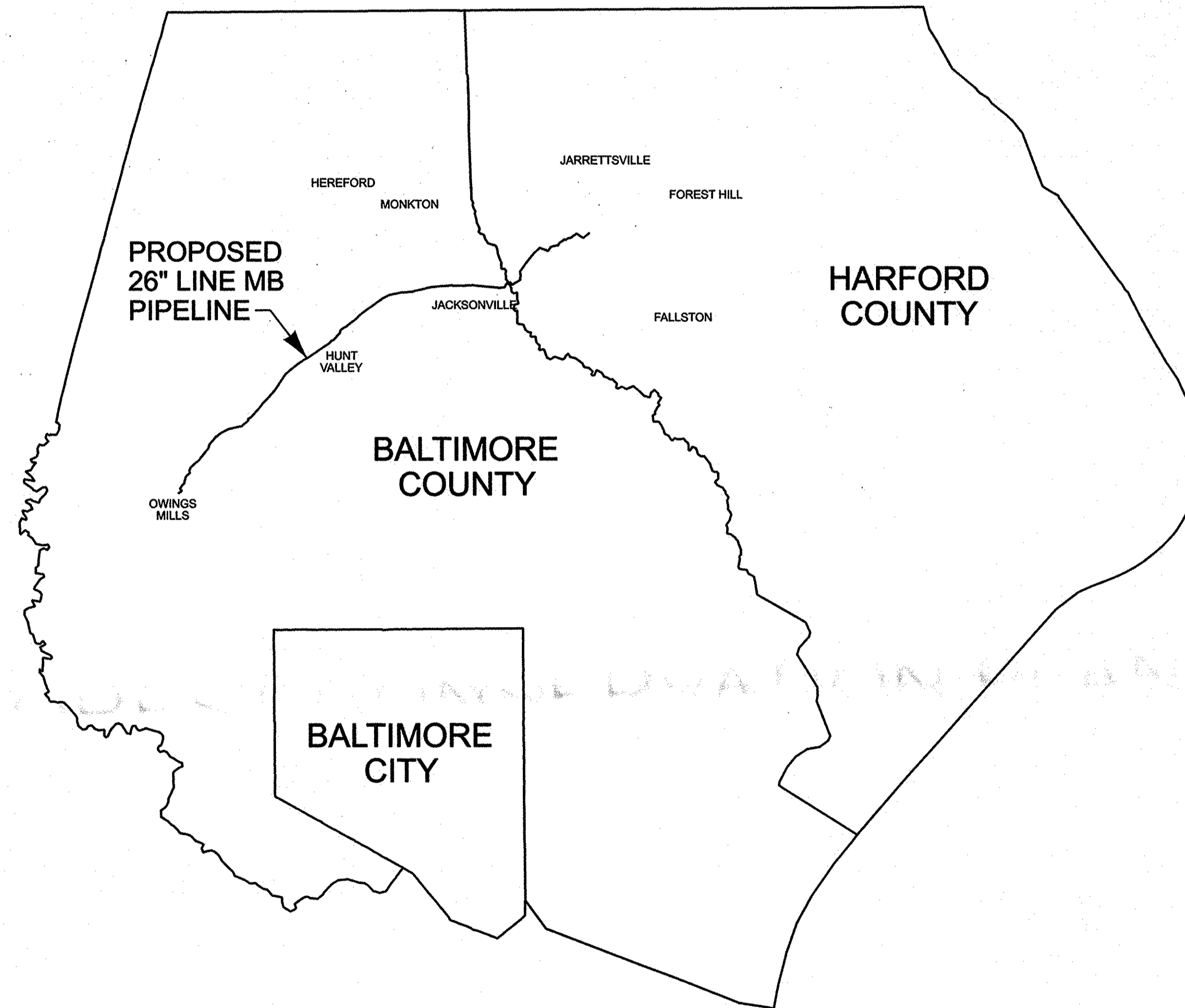

**LEGEND**

- 600 --- EX. CONTOUR
- SD---SD--- EX. STORM DRAIN
- W--- EX. WATER UTILITY LINE
- FO--- EX. FIBER OPTIC LINE
- //--- EX. FOREIGN PIPELINE
- OH--- EX. OVERHEAD ELECTRIC
- E--- EX. UNDERGROUND ELECTRIC
- T--- EX. UNDERGROUND TELEPHONE
- MA--- EX. LINE MA GAS LINE
- X---X--- EX. FENCE
- EX. STREAM
- PUBLIC ROAD RIGHT-OF-WAY
- PROPERTY LINE
- EX. EASEMENT
- EX. FOREST EASEMENT
- MB---MB--- PROPOSED LINE MB NATURAL GAS PIPELINE
- LINE MB PERMANENT RIGHT-OF-WAY
- LINE MB TEMPORARY WORKSPACE
- LINE MB ADDITIONAL TEMPORARY WORKSPACE
- EXISTING LINE MA RIGHT-OF-WAY
- PROPOSED ACCESS ROAD CENTERLINE
- PROPOSED CONTRACTOR STAGING AREA
- 100 YEAR FLOODPLAIN
- SOILS DELINEATION
- MaC  
GdB  
SLOPES 15-25%
- SLOPES 25% OR GREATER
- WUS --- FIELD DELINEATED WATERS OF THE U.S.
- NON-TIDAL WETLAND
- WB --- 25' MDE REGULATED WETLAND BUFFER
- FOREST STAND BOUNDARY LINE SURVEYED BY KCI
- FB --- FOREST BUFFER
- EX. VEGETATION LINE X
- EX. TREE
- FOREST DATA COLLECTION POINT
- SP-1 --- SPECIMEN TREE
- TREE TO BE REMOVED
- FOREST STAND BREAK
- STUDY AREA BOUNDARY
- LOD --- LIMIT OF DISTURBANCE
- SF --- SILT FENCE
- SSF --- SUPER SILT FENCE
- FOREST CLEARING WITHIN BALTIMORE COUNTY (BC) FOREST CONSERVATION EASEMENT (FCE) / FOREST BUFFER EASEMENT (FBE)
- FOREST CLEARING WITHIN FOREST BUFFER OUTSIDE OF BALTIMORE COUNTY FOREST CONSERVATION EASEMENT (FCE) / FOREST BUFFER EASEMENT (FBE)
- FOREST CLEARING OUTSIDE FCE, FBE, AND FOREST BUFFER (FB)
- PROPOSED STREAMBANK PLANTING
- FOREST BUFFER / CONSERVATION EASEMENT REPLANTING AREAS

DESCRIPTION	BALTIMORE COUNTY	DESCRIPTION	BALTIMORE COUNTY
TOTAL PROPOSED FOREST CLEARING	5.38 AC.	TOTAL NUMBER OF SPECIMEN TREES IDENTIFIED WITHIN THE SURVEY CORRIDOR DURING FIELD INVESTIGATIONS	178
TOTAL PROPOSED FOREST CLEARING WITHIN BALTIMORE COUNTY FOREST CONSERVATION EASEMENT (FCE) & FOREST BUFFER EASEMENT (FBE)	0.00 AC.	TOTAL NUMBER OF PROPOSED SPECIMEN TREES WITHIN FOREST STANDS TO BE REMOVED	57
TOTAL PROPOSED FOREST CLEARING WITHIN FOREST BUFFER (FB) OUTSIDE BALTIMORE COUNTY FOREST CONSERVATION EASEMENT (FCE) / FOREST BUFFER EASEMENT (FBE)	0.15 AC.	TOTAL NUMBER OF PROPOSED SPECIMEN TREES OUTSIDE FOREST STANDS TO BE REMOVED	6
TOTAL PROPOSED FOREST CLEARING OUTSIDE FOREST CONSERVATION EASEMENT (FCE) / FOREST BUFFER EASEMENT (FBE) AND FOREST BUFFER (FB)	5.23 AC.		
TOTAL PROPOSED PLANTING / REPLANTING ON-SITE X	0.07 AC.		
TOTAL PROPOSED PLANTING OFF-SITE AT UNDETERMINED LOCATION	5.31 AC.		

**SHEET INDEX**

- T-1 TITLE SHEET
- VIC-1 TO VIC-2 VICINITY MAP
- GN-1 FOREST CONSERVATION NOTES AND DETAILS
- FCP-52 TO FCP-60 BALTIMORE COUNTY FOREST CONSERVATION PLAN / FOREST BUFFER PROTECTION PLAN
- PO-1 ADJACENT PROPERTY OWNER INFORMATION
- ET-1 EASEMENT INFORMATION

PLOTTED: 11/14 AM on Thursday, August 22, 2013  
 BY: Amanda Wagoner, Division: PDS, Nature Res Emp  
 FILE: MA-2013-16121849.dwg, title: FCP - TITL - SH1 - BALT. CO. PHASE 1.dgn

BALTIMORE COUNTY  
 DEPARTMENT OF ENVIRONMENTAL PROTECTION  
 AND SUSTAINABILITY  
 FOREST CONSERVATION PLAN APPROVAL  
 Approved by: *Jennifer Bird* Date: 8/13/13  
 MDNR approved professional  
 FOREST CONSERVATION PLAN # FC 13-046

BALTIMORE COUNTY  
 DEPARTMENT OF ENVIRONMENTAL PROTECTION  
 AND SUSTAINABILITY  
 Forest Buffer Protection Plan Approval  
 Approved by: *John G. Rame* Date: 8/13/13  
 MDNR approved professional  
 Forest Buffer Protection Plan # FBP 13-026

**OWNER**

NIOURCE / COLUMBIA GAS TRANSMISSION, LLC  
 1700 McCORKLE AVE., SE  
 CHARLESTON, WV 25314  
 TELE: (304) 357-2040  
 CONTACT: JENNIFER L. FRANCO

THIS PLAN WAS PREPARED BY:  
 JENNIFER BIRD  
 KCI TECHNOLOGIES  
 MDNR QUALIFIED PROFESSIONAL  
 STATUS (SEPTEMBER 2011)  
*Jennifer Bird* 08/2013  
 SIGNATURE DATE

ENGINEERS  
 PLANNERS  
 SCIENTISTS  
 CONSTRUCTION MANAGERS  
**KCI**  
 TECHNOLOGIES  
 936 RIDGEBROOK ROAD  
 SPARKS, MARYLAND 21152  
 TELEPHONE: (410) 316-7800  
 FAX: (410) 316-7818

Columbia Gas  
 Transmission  
 A NiSource Company

REVISIONS			
NO.	DATE	DESCRIPTION	BY

FOREST CONSERVATION PLAN / FOREST BUFFER PROTECTION PLAN FOR COLUMBIA GAS TRANSMISSION, LLC LINE MB PIPELINE EXTENSION PROJECT PHASE 1 BALTIMORE COUNTY, MARYLAND		DRAWING NO. <b>T-1</b> SHEET 1 OF 15 KCI JOB NUMBER 16-121849
---	--	---

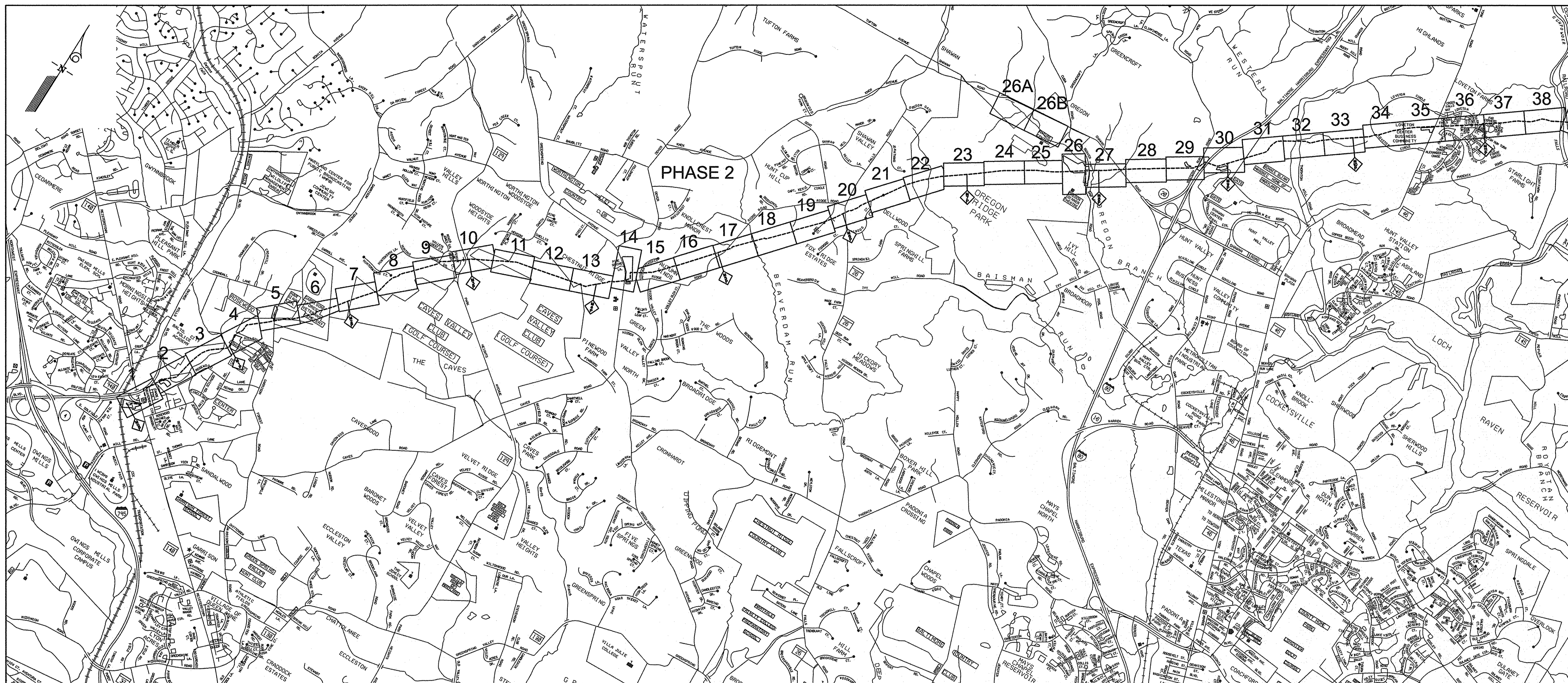

**NOTE:**

1. PLAN SHEETS FCP-1 THROUGH FCP-38 IN BALTIMORE COUNTY (SHOWN IN GRAY FOR PHASE 2 CONSTRUCTION) ARE NOT INCLUDED IN THIS PLAN SET.

**VICINITY MAP**

1" = 2000'

PLOTTED: 02:12 PM on Thursday, August 01, 2013  
 BY: Amanda Wagoner, Division: P&S, Natural Res. Emp.  
 FILE: M:\2012\121818\Drawings\NCP\_FCP\_BAL\_CO\_LOCATION\_PLAN\_PHASE-1.dgn

**BALTIMORE COUNTY**  
 DEPARTMENT OF ENVIRONMENTAL PROTECTION  
 AND SUSTAINABILITY  
 FOREST CONSERVATION PLAN APPROVAL  
 Approved by: *[Signature]* Date: 8/30/13  
 FOREST CONSERVATION PLAN # **FC-13-046**

**BALTIMORE COUNTY**  
 DEPARTMENT OF ENVIRONMENTAL PROTECTION  
 AND SUSTAINABILITY  
 Forest Buffer Protection Plan Approval  
 Approved by: *[Signature]* Date: 8/30/13  
 Environmental Impact Review  
 Forest Buffer Protection Plan # **FBP-13-026**

THIS PLAN WAS PREPARED BY:  
 JENNIFER BIRD  
 KCI TECHNOLOGIES  
 MONITOR QUALIFIED PROFESSIONAL  
 STATUS (SEPTEMBER 2011)  
*[Signature]* 08/2013  
 SIGNATURE DATE

**KCI**  
 TECHNOLOGIES  
 ENGINEERS  
 PLANNERS  
 SCIENTISTS  
 CONSTRUCTION MANAGERS  
 936 RIDGEBROOK ROAD  
 SHARPS, MARYLAND 21152  
 TELEPHONE: (410) 316-7800  
 FAX: (410) 316-7818

**Columbia Gas**  
 Transmission  
 A NiSource Company

REVISIONS				DATE
NO.	DATE	DESCRIPTION	BY	AUGUST 2013

SCALE  
 1" = 50'  
 DESIGNED BY  
 JB  
 DRAWN BY  
 CSD

**VICINITY MAP**  
 FOR  
**COLUMBIA GAS TRANSMISSION, LLC**  
**LINE MB EXTENSION PROJECT**  
**PHASE 1**  
 BALTIMORE COUNTY, MARYLAND

DRAWING NO.  
**VIC-1**  
 SHEET 2 OF 15  
 KCI JOB NUMBER  
 16-121849

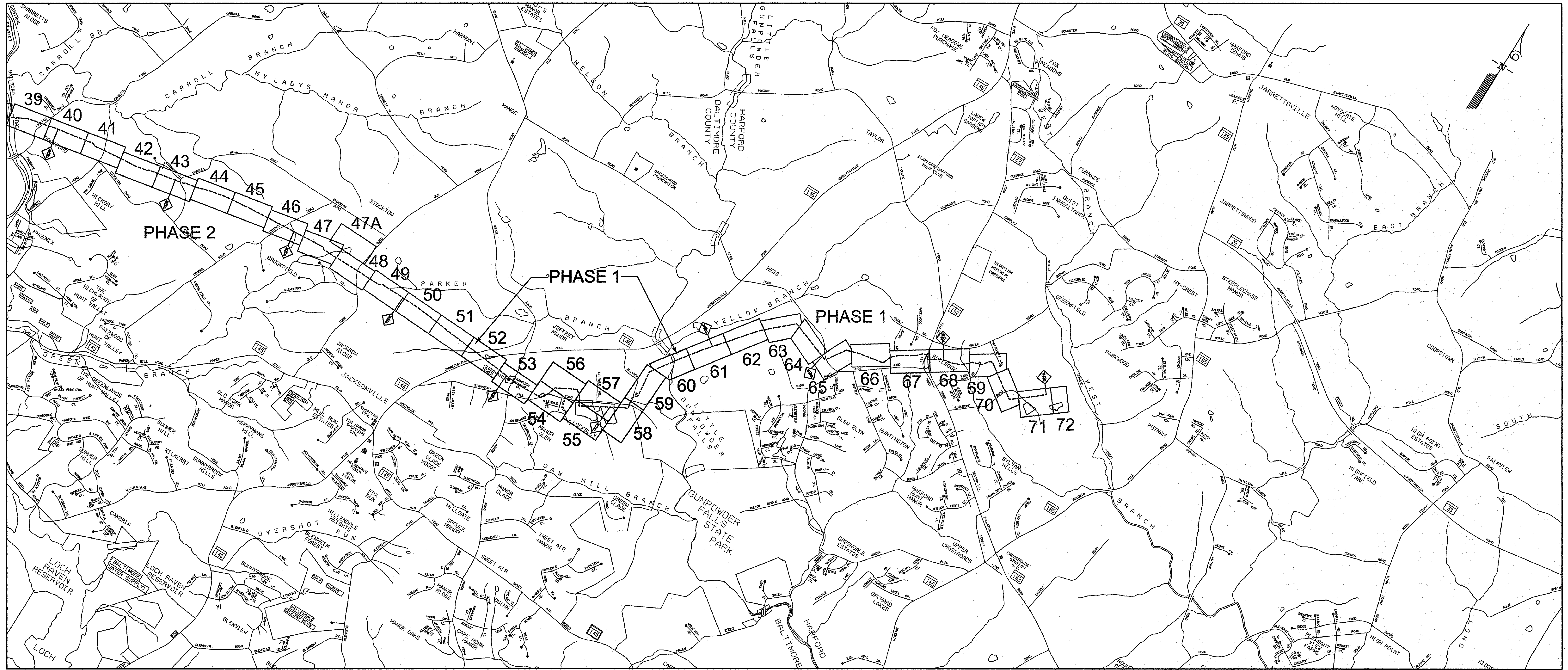

**VICINITY MAP**

1" = 2000'

**NOTE:**

PLEASE REFER TO BALTIMORE COUNTY PLAN SHEETS FCP-52 THROUGH FCP-60 WHEN USING THE SHEET REFERENCE NUMBERS LISTED ABOVE. BALTIMORE COUNTY SHEETS FCP-39 THROUGH FCP-51, SHOWN IN GRAY, ARE FOR PHASE 2 CONSTRUCTION AND ARE NOT SHOWN IN THIS PLAN SET. HARFORD COUNTY SHEETS FCP-61 THROUGH FCP-72, SHOWN IN GRAY, ARE NOT INCLUDED IN THIS PLAN SET.

PLOTTED: 02:12 PM on Thursday, August 01, 2013  
 BY: jmc  
 FILE: \data\projects\2013\Forest Conservation Plan\FCP-13-026\LOCATION PLAN PHASE 1.dwg

BALTIMORE COUNTY  
 DEPARTMENT OF ENVIRONMENTAL PROTECTION  
 AND SUSTAINABILITY  
 FOREST CONSERVATION PLAN APPROVAL  
 Approved by: [Signature] Date: 8/20/13  
 Environmental Impact Review  
 Approved professional  
 FOREST CONSERVATION PLAN # FCP-13-026

BALTIMORE COUNTY  
 DEPARTMENT OF ENVIRONMENTAL PROTECTION  
 AND SUSTAINABILITY  
 Forest Buffer Protection Plan Approval  
 Approved by: [Signature] Date: 8/20/13  
 Environmental Impact Review  
 Approved professional  
 Forest Buffer Protection Plan # FBP-13-026

THIS PLAN WAS PREPARED BY:  
 JENNIFER BIRD  
 KCI TECHNOLOGIES  
 MDNR QUALIFIED PROFESSIONAL  
 STATUS (SEPTEMBER 2011)  
 [Signature]  
 SIGNATURE DATE 08/20/13

**KCI** TECHNOLOGIES  
 ENGINEERS  
 PLANNERS  
 SCIENTISTS  
 CONSTRUCTION MANAGERS  
 936 RIDGEBROOK ROAD  
 SUITE 200, BALTIMORE, MD 21286  
 TELEPHONE: (410) 316-7800  
 FAX: (410) 316-7818

**Columbia Gas Transmission, LLC**  
 A NISOURCE COMPANY

REVISIONS				DATE	
NO.	DATE	DESCRIPTION	BY	AUGUST 2013	

SCALE  
 1" = 50'  
 DESIGNED BY  
 JB  
 DRAWN BY  
 CSD

**VICINITY MAP**  
 FOR  
 COLUMBIA GAS TRANSMISSION, LLC  
 LINE MB EXTENSION PROJECT  
 PHASE 1  
 BALTIMORE COUNTY, MARYLAND

DRAWING NO.  
**VIC-2**  
 SHEET 3 OF 15  
 KCI JOB NUMBER  
 16-121849

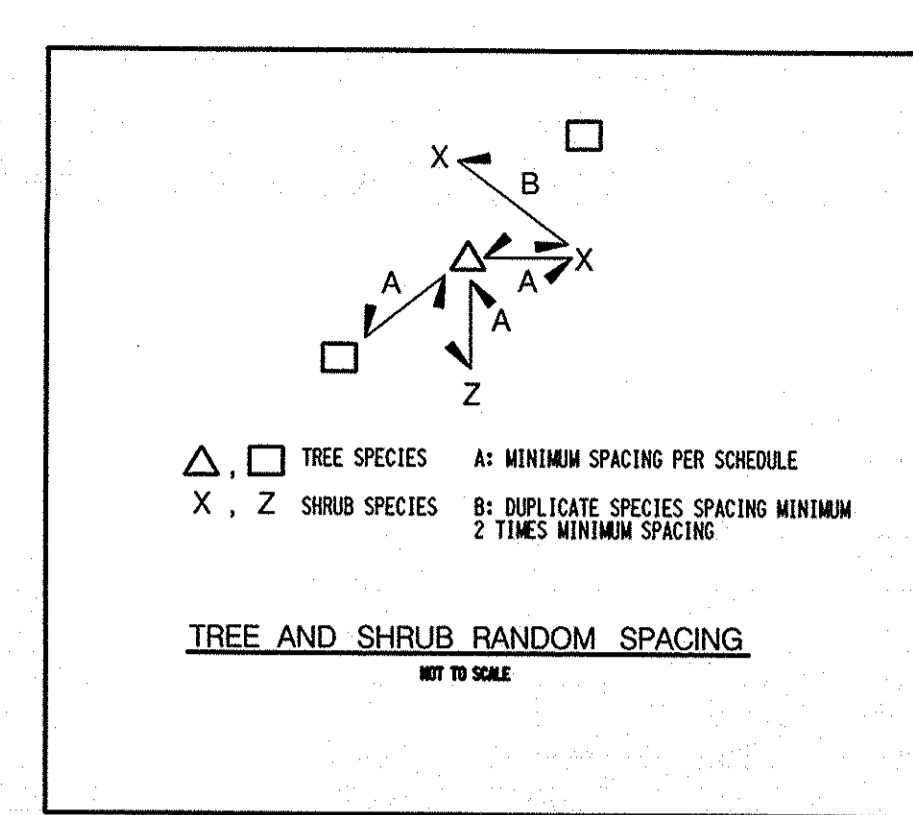
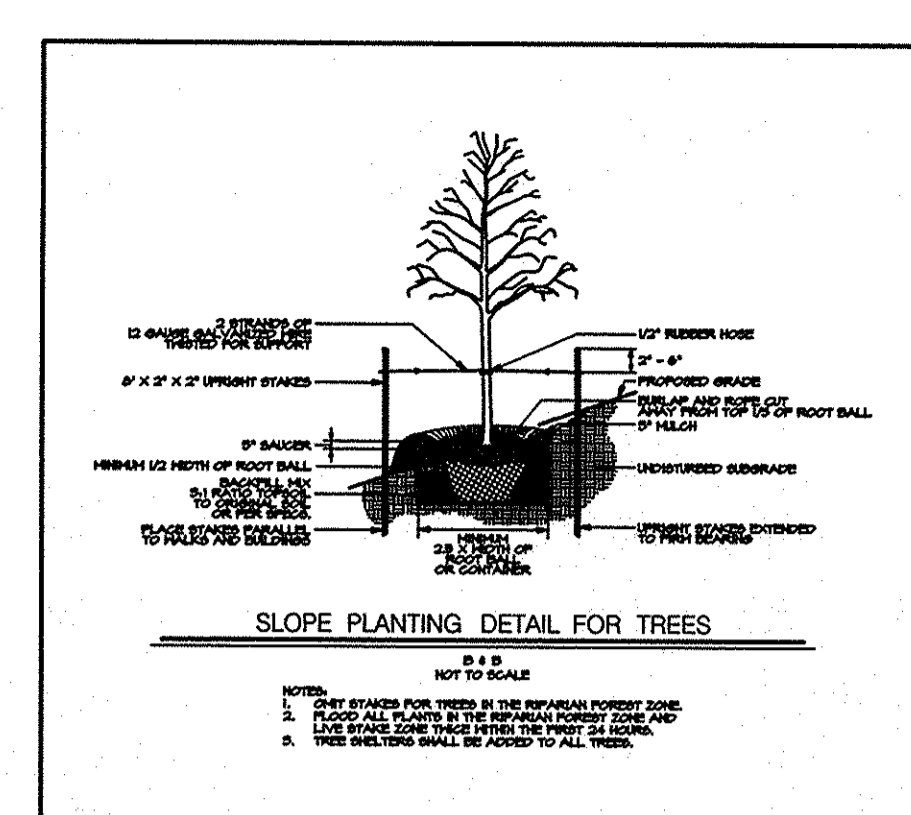
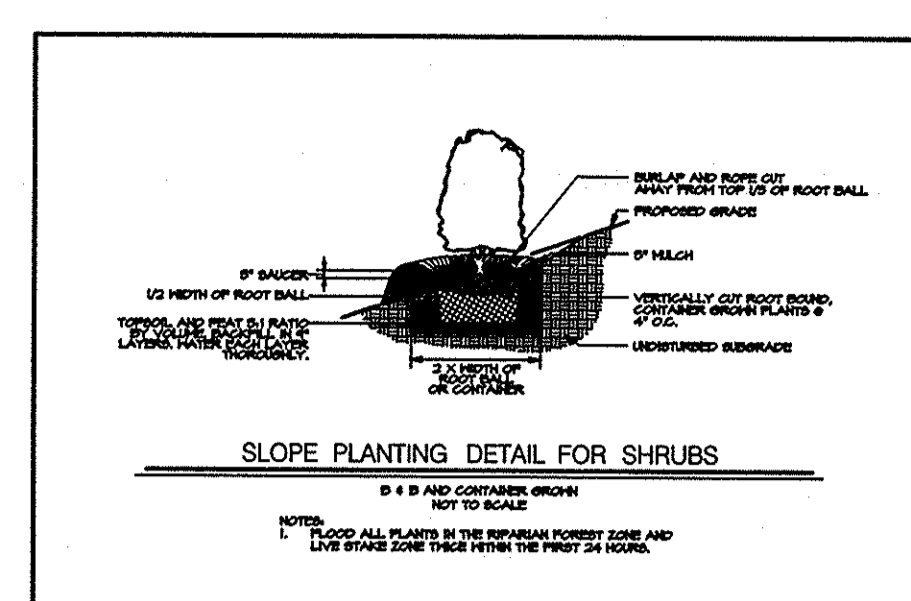
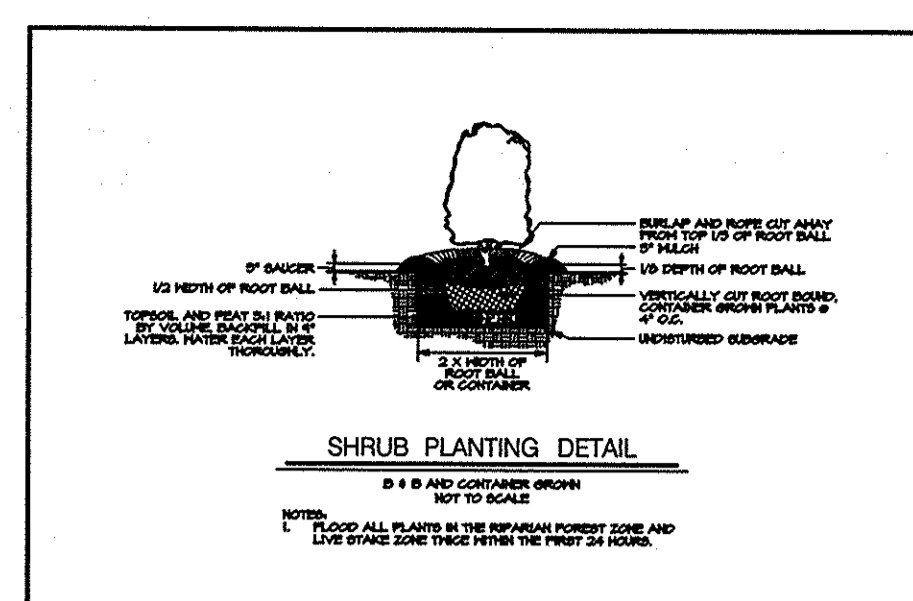
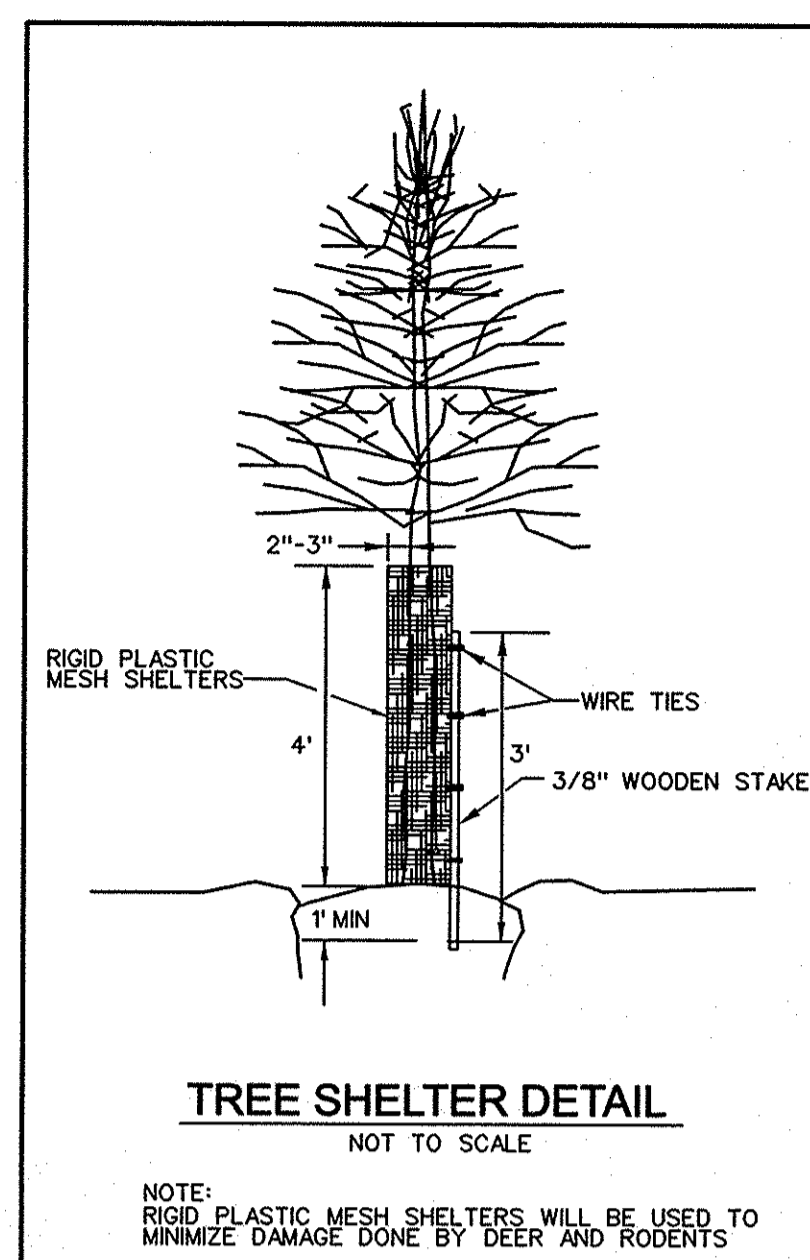
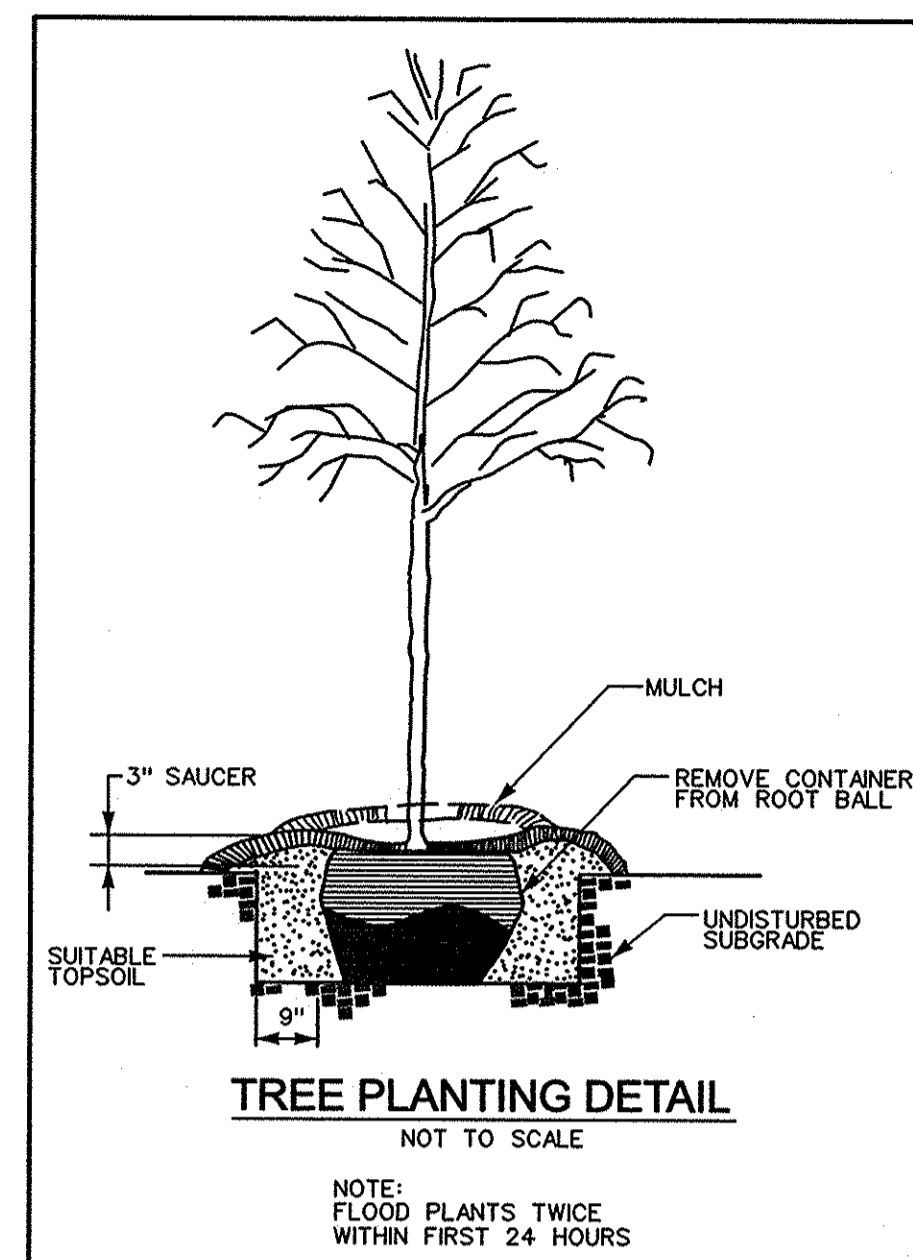

SOILS TABLE				
Soil Symbol	Soil Unit Name	Percent Slope	K <sub>v</sub> value	Hydric (Y/N)
Baltimore County				
CA	Codorus silt loams	0-3	0.37	N
QaB	Galita loam	3-8	0.24	N
QaC	Galita loam	8-15	0.24	N
GdA	Glenelg loam	0-3	0.28	N
GdB	Glenelg loam	3-8	0.28	N
GdC	Glenelg loam	8-15	0.28	N
GhB	Glenville silt loam	3-8	0.37	N
GhC	Glenville silt loam	8-15	0.37	N
MaC	Manor loam	8-15	0.24	N
MaD	Manor loam	15-25	0.24	N
MbC	Manor channery loam	8-15	0.24	N
MbD	Manor channery loam	15-25	0.24	N
MdE	Manor-Brinklow complex	25-45	0.24	N

FOREST STAND SUMMARY				
Stand	Type	Size (AC)	Priority Retention	Sheet No.
JJ	Tulip Poplar - Mixed Oak	9.59	Priority 1: High	50, 51, 52
KK	Tulip Poplar - Black Gum	3.37	Priority 1: High	52, 53
LL	Tulip Poplar - Red Maple	1.92	Priority 2: Moderate	53
MM	Red Maple - Virginia Pine	0.61	Priority 2: Moderate	53, 54
NN	Tulip Poplar	0.97	Priority 2: Moderate	54
FF	Tulip Poplar - Northern Red Oak	1.92	Priority 2: Moderate	54, 56
GG	Mixed Oak	1.69	Priority 1: High	56
HH	Mixed Oak - Tulip Poplar	2.26	Priority 2: Moderate	56, 57
OO	Black Cherry - Black Locust - Black Walnut	0.10	Priority 4: Disturbed	55
YY	Tulip Poplar - Red Maple	0.09	Priority 3: Low	55
ZZ	Tulip Poplar - Sassafras	1.58	Priority 2: Moderate	57, 58
AAA	Tulip Poplar - Northern Red Oak	0.19	Priority 1: High	58, 59
QQ	Tulip Poplar - Mixed Oak	0.81	Priority 1: High	59, 60
BBB	Honey Locust - American Sycamore	2.58	Priority 1: High	60

### VEGETATION MAINTENANCE

**Maintenance**  
This project will be inspected and maintained for a period of three years after planting. Annual Maintenance Reports will be submitted to Baltimore County Department of Environmental Protection and Sustainability (BCDEPS) each year summarizing issues and maintenance tasks completed at each replanting site.

**Watering**  
Reforestation plantings will require watering during periods of intense heat or drought. Appropriate watering will consist of 5-10 gallons per tree once a week.

**Mulching**  
If necessary, mulch will be topped once a year in the spring for each of the three years of required maintenance.

**Tree Shelters, Bark Protectors, and Stake Reinforcement**  
Tree shelters, bark protectors, and stakes will be readjusted when fallen, leaning, or bent.

**Weeding**  
If necessary, mulch rags will be weeded during the spring and summer growing seasons.

**Vine Removal**  
Vines will be cleared away from trees and bark protectors.

**Invasive Plant and Pest Control**  
If invasive plant or animal species are found to be a consistent problem, BCDEPS will be notified immediately for pesticide application (includes herbicide and rodenticide) and/or removal of vines.

**Pruning**  
Pruning will be limited to:  
• the removal of dead, dying, or severely diseased branches,  
• branches growing toward or across the tree's center, and  
• sprouts forming at the base of the trunk.

**Mowing**  
If necessary, seasonal mowing will be performed to suppress invasive and undesirable pioneer species.

**Quality Assurance**  
The tree survival goal for reforestation sites is 75%. If at any point the survival count falls below those numbers within the three year maintenance period, a tree replacement will be performed in order to re-attain or exceed the necessary quantity of healthy trees.

### BINDING THREE YEAR MAINTENANCE AGREEMENT/FCP/FP

The undersigned hereby accept responsibility for a three year binding maintenance agreement for the Forest Conservation and Forest Buffer Mitigation Plan plantings as shown on the approved Forest Conservation and Forest Buffer Protection Plan. The binding agreement includes:

- Watering shall occur when the plants are installed and as required to assure good plant growth. During the first growing season, plants shall receive one gallon of water per week through watering or natural precipitation. During the second and third growing seasons, plants shall be watered in July and August on an as-needed basis.
- Use of fertilizer is not recommended during the first growing season. Fertilizers should be used during the second and third growing seasons on an as-needed basis, as determined by soil analysis.
- Competing and exotic/invasive plants shall be controlled through selective mowing, spraying, or hand removal, as indicated on the approved Forest Conservation and Forest Buffer Protection Plan.
- Plants shall be protected from diseases, pests and mechanical injury.
- Plants shall be replaced when the survival rate falls below 75 percent of the original number of plants installed. Replacement shall occur during the next growing season.

I certify that I have reviewed and agree to comply with this Forest Conservation and Forest Buffer Protection Plan and the binding Three Year Maintenance Agreement. I agree to notify Baltimore County DEPS upon completion of the initial planting and at the end of each year of the three year maintenance agreement.

*Jerry Castillo* 08/2013  
Owner's Signature Date

JERRY CASTILLO, COLUMBIA GAS TRANSMISSION, LLC • 713-386-3467  
Owner's Name (Printed) Phone Number

### PLANT SCHEDULE

Botanical Name	Common Name	Size	Spacing	Quantity	Indicator
<b>Shrub</b>					
<i>Amelanchier canadensis</i>	Serviceberry	3' Height	6' o.c.	2	FAC
<i>Hamamelis virginiana</i>	Witch Hazel	3' Height	6' o.c.	2	FACU
<i>Lindera benzoin</i>	Spicebush	3' Height	6' o.c.	2	FACU
<i>Viburnum angustifolium</i>	Lowbush Blueberry	3' Height	6' o.c.	2	N/A
<i>Viburnum acerifolium</i>	Maple Leaved Arrowwood	3' Height	6' o.c.	2	UPL
<b>Small Trees</b>					
<i>Nyssa sylvatica</i>	Black Gum	5' height	15' o.c.	2	FAC
<i>Prunus serotina</i>	Black Cherry	5' height	15' o.c.	1	FACU
<i>Sassafras albidum</i>	Sassafras	5' height	15' o.c.	1	FACU
<b>Canopy Layer</b>					
<i>Acer rubrum</i>	Red Maple	5' height	20' o.c.	1	FAC
<i>Liriodendron tulipifera</i>	Tulip Poplar	5' height	20' o.c.	1	FACU
<i>Quercus prinus</i>	Chestnut Oak	5' height	20' o.c.	1	UPL
<i>Quercus rubra</i>	Northern Red Oak	5' height	20' o.c.	2	FACU

Note: FAC plants should be distributed evenly along the easement corridor. FACU and UPL plants should be concentrated in upland areas along the easement corridor. Plants with N/A indicator should be concentrated in upland areas along the easement corridor.

Note: Planting will occur within one year or two growing seasons upon project completion.

Proposed Planting/Replanting On-Site		
Sheet #	Planting/Replanting Area	Forest Buffer
52		0.03 Forest Buffer
56		0.05 Forest Buffer
<b>Total Planting</b>		<b>0.07</b>

PLOTTED: 10:06 PM on Wednesday, August 28, 2013  
 FILE: M:\2012\121843\Drawings\A-E-DETAILS-BALT\_CO\_PHASE-1.dwg

BALTIMORE COUNTY  
DEPARTMENT OF ENVIRONMENTAL PROTECTION  
AND SUSTAINABILITY  
FOREST CONSERVATION PLAN APPROVAL  
Approved by: *Jennifer Bird* Date: 8/20/13  
Professional Engineer  
Forest Conservation Plan # FC 13-046

BALTIMORE COUNTY  
DEPARTMENT OF ENVIRONMENTAL PROTECTION  
AND SUSTAINABILITY  
Forest Buffer Protection Plan Approval  
Approved by: *Jerry Castillo* Date: 8/20/13  
Professional Engineer  
Forest Buffer Protection Plan # FBP 13-026

THIS PLAN WAS PREPARED BY:  
JENNIFER BIRD  
KCI TECHNOLOGIES  
MDNR QUALIFIED PROFESSIONAL  
STATUS (SEPTEMBER 2011)  
*Jennifer Bird* 08/2013  
SIGNATURE DATE

ENGINEERS  
PLANNERS  
SCIENTISTS  
CONSTRUCTION MANAGERS  
**KCI**  
TECHNOLOGIES  
936 RIDGEBROOK ROAD  
SPARKS, MARYLAND 21152  
TELEPHONE: (410) 316-7800  
FAX: (410) 316-7818

Columbia Gas  
Transmission  
A NiSource Company

REVISIONS			
NO.	DATE	DESCRIPTION	BY

DATE: AUGUST 2013  
SCALE: 1" = 50'  
DESIGNED BY: JB  
DRAWN BY: CSD

FOREST CONSERVATION NOTES AND DETAILS  
FOR  
COLUMBIA GAS TRANSMISSION, LLC  
LINE MB EXTENSION PROJECT  
PHASE 1  
BALTIMORE COUNTY, MARYLAND

DRAWING NO.  
**GN-1**  
SHEET 4 OF 15  
KCI JOB NUMBER  
16-121849

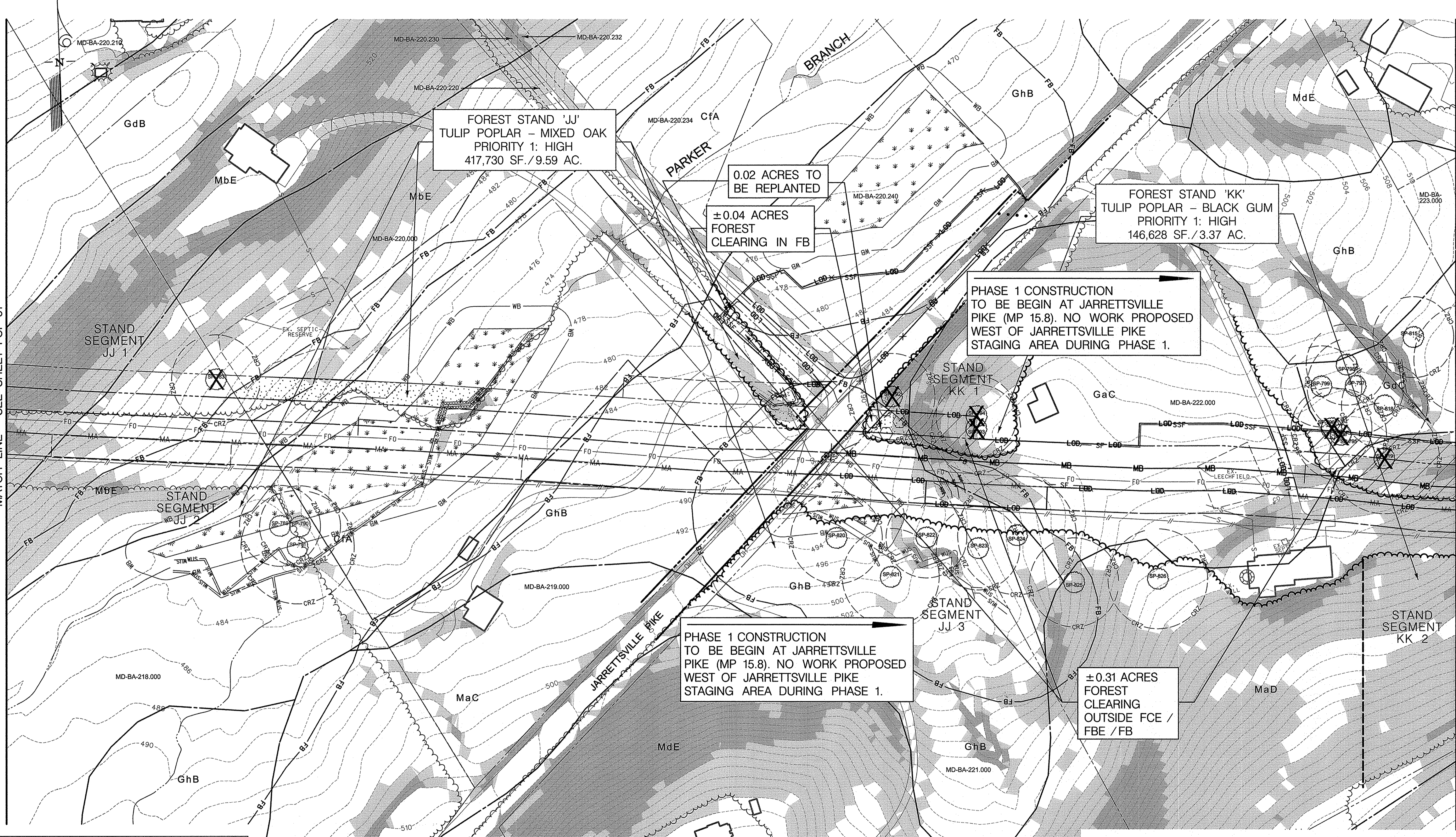

MATCH LINE - SEE SHEET FCP-51

MATCH LINE - SEE SHEET FCP-53

Number	Species	Common Name	Size, DBH (in)	Condition	Notes
SP-792	Carya tomentosa	Mockernut Hickory	32.0	Good	Forest Tree, To Be Removed
SP-793	Quercus rubra	Northern Red Oak	33.0	Good	Forest Tree, To Be Removed
SP-794	Quercus rubra	Northern Red Oak	30.0	Good	Forest Tree, To Be Removed
SP-795	Liriodendron tulipifera	Tulip Poplar	34.0	Good	Forest Tree, To Be Removed
SP-796	Liriodendron tulipifera	Tulip Poplar	30.0	Good	Forest Tree, To Be Removed
SP-797	Quercus rubra	Northern Red Oak	35.0	Good	Forest Tree
SP-798	Carya glabra	Pignut Hickory	30.0	Good	Forest Tree
SP-799	Quercus alba	White Oak	30.0	Good	Forest Tree
SP-815	Carya glabra	Pignut Hickory	30.0	Good	Forest Tree
SP-818	Carya tomentosa	Mockernut Hickory	32.0	Good	Forest Tree
SP-819	Liriodendron tulipifera	Tulip Poplar	41.0	Good	Forest Tree, To Be Removed
SP-820	Quercus alba	White Oak	34.0	Fair	Forest Tree
SP-821	Liriodendron tulipifera	Tulip Poplar	36.0	Good	Forest Tree
SP-822	Quercus alba	White Oak	30.0	Good	Forest Tree
SP-823	Quercus alba	White Oak	31.0	Poor	Forest Tree
SP-824	Quercus velutina	Black Oak	44.0	Good	Forest Tree
SP-825	Quercus rubra	Northern Red Oak	33.0	Good	Forest Tree
SP-826	Quercus velutina	Black Oak	37.0	Good	Forest Tree

Total Specimen Trees on This Sheet = 18  
Total Specimen Trees Removed on This Sheet = 6

**BALTIMORE COUNTY**  
DEPARTMENT OF ENVIRONMENTAL PROTECTION AND SUSTAINABILITY  
FOREST CONSERVATION PLAN APPROVAL  
Approved by: *[Signature]* Date: 8/30/13  
Forest Conservation Plan # **FC 13-046**

**BALTIMORE COUNTY**  
DEPARTMENT OF ENVIRONMENTAL PROTECTION AND SUSTAINABILITY  
Forest Buffer Protection Plan Approval  
Approved by: *[Signature]* Date: 8/30/13  
Environmental Impact Review  
Forest Buffer Protection Plan # **FBP13-026**

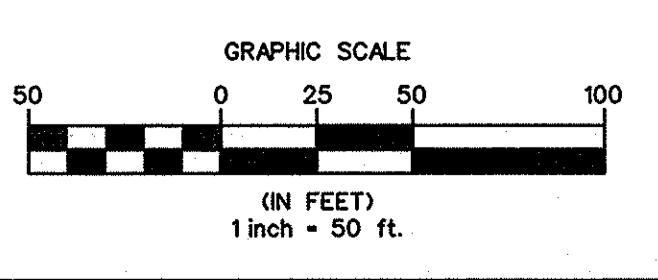

THIS PLAN WAS PREPARED BY:  
JENNIFER BIRD  
KCI TECHNOLOGIES  
MDNR QUALIFIED PROFESSIONAL STATUS (SEPTEMBER 2011)  
*[Signature]* 08/2013  
SIGNATURE DATE

**KCI TECHNOLOGIES**  
ENGINEERS PLANNERS SCIENTISTS CONSTRUCTION MANAGERS  
936 RICEBROOK ROAD  
SHARPS, MARYLAND 21152  
TELEPHONE: (410) 316-7800  
FAX: (410) 316-7818

**Columbia Gas Transmission**  
A NiSource Company

NO.	DATE	REVISIONS DESCRIPTION	BY	DATE
				AUGUST 2013
				SCALE
				1" = 50'
				DESIGNED BY
				JB
				DRAWN BY
				CSD

FOREST CONSERVATION PLAN / FOREST BUFFER PROTECTION PLAN FOR COLUMBIA GAS TRANSMISSION, LLC LINE MB EXTENSION PROJECT PHASE 1  
BALTIMORE COUNTY, MARYLAND

DRAWING NO. **FCP-52**  
SHEET 5 OF 15  
KCI JOB NUMBER 16-121849

TOTAL FOREST CLEARING WITHIN BC FCE / FBE: 0.00 AC  
TOTAL FOREST CLEARING WITHIN FB: 0.04 AC.  
TOTAL FOREST CLEARING OUTSIDE FCE / FBE / FB: 0.31 AC.  
TOTAL AREA REPLANTED ON-SITE: 0.02 AC.  
TOTAL AREA REQUIRING OFF-SITE MITIGATION: 0.33 AC.

PLOTTED: 02:15 PM on Thursday, August 01, 2013  
BY: Amanda Wagoner, Division: F050, Natural Resources  
FILE: M:\2012\1621849\Drawings\FCP\MB\_S2\_PHASE-1.dwg

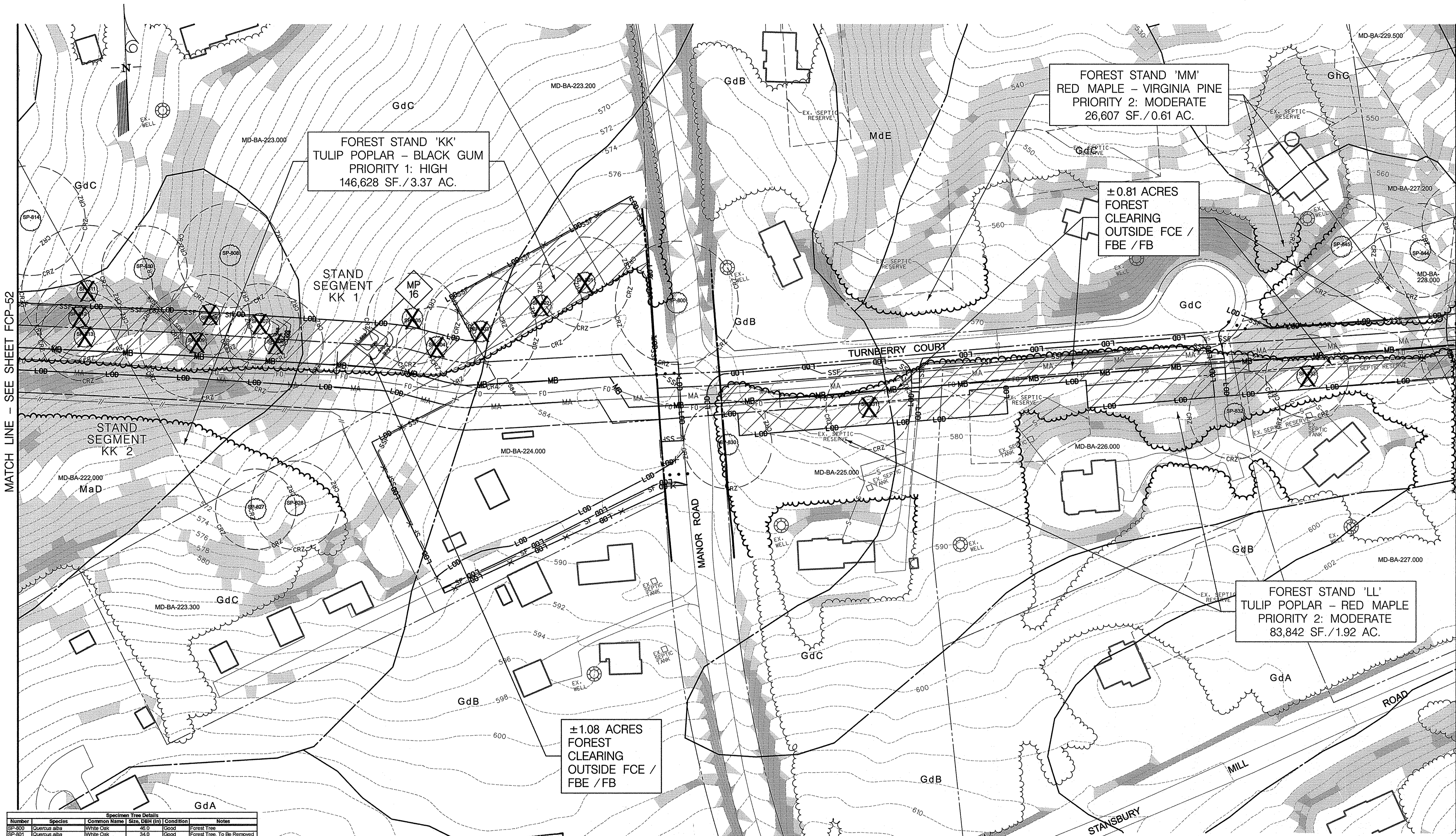

FOREST STAND 'KK'  
TULIP POPLAR - BLACK GUM  
PRIORITY 1: HIGH  
146,628 SF./3.37 AC.

FOREST STAND 'MM'  
RED MAPLE - VIRGINIA PINE  
PRIORITY 2: MODERATE  
26,607 SF./0.61 AC.

±0.81 ACRES  
FOREST  
CLEARING  
OUTSIDE FCE /  
FBE / FB

FOREST STAND 'LL'  
TULIP POPLAR - RED MAPLE  
PRIORITY 2: MODERATE  
83,842 SF./1.92 AC.

±1.08 ACRES  
FOREST  
CLEARING  
OUTSIDE FCE /  
FBE / FB

MATCH LINE - SEE SHEET FCP-52

MATCH LINE - SEE SHEET FCP-54

Number	Species	Common Name	Size, DBH (in)	Condition	Notes
SP-800	Quercus alba	White Oak	48.0	Good	Forest Tree
SP-801	Quercus alba	White Oak	34.0	Good	Forest Tree, To Be Removed
SP-802	Liriodendron tulipifera	Tulip Poplar	33.0	Good	Forest Tree, To Be Removed
SP-803	Quercus alba	White Oak	42.0	Good	Forest Tree, To Be Removed
SP-804	Quercus alba	White Oak	30.0	Good	Forest Tree, To Be Removed
SP-805	Liriodendron tulipifera	Tulip Poplar	34.0	Good	Forest Tree, To Be Removed
SP-806	Quercus alba	White Oak	36.0	Good	Forest Tree, To Be Removed
SP-807	Liriodendron tulipifera	Tulip Poplar	30.0	Good	Forest Tree, To Be Removed
SP-808	Liriodendron tulipifera	Tulip Poplar	39.0	Good	Forest Tree
SP-809	Platanus occidentalis	Sycamore	42.0	Good	Forest Tree, To Be Removed
SP-810	Acer rubrum	Red Maple	32.0	Good	Forest Tree
SP-811	Quercus alba	White Oak	49.0	Good	Forest Tree, To Be Removed
SP-812	Liriodendron tulipifera	Tulip Poplar	32.0	Good	Forest Tree, To Be Removed
SP-813	Acer rubrum	Red Maple	33.0	Good	Forest Tree, To Be Removed
SP-814	Liriodendron tulipifera	Tulip Poplar	41.0	Good	Forest Tree
SP-827	Platanus occidentalis	Sycamore	30.0	Fair	Forest Tree
SP-828	Liriodendron tulipifera	Tulip Poplar	33.0	Good	Forest Tree
SP-829	Quercus velutina	Black Oak	30.0	Fair	Forest Tree, To Be Removed
SP-830	Acer rubrum	Red Maple	33.0	Good	Forest Tree, To Be Removed
SP-831	Acer rubrum	Red Maple	32.0	Good	Forest Tree, To Be Removed
SP-832	Liriodendron tulipifera	Tulip Poplar	34.0	Good	Forest Tree
SP-833	Acer rubrum	Red Maple	31.0	Good	Forest Tree, To Be Removed
SP-844	Quercus velutina	Black Oak	36.0	Good	Forest Tree
SP-845	Liriodendron tulipifera	Tulip Poplar	37.0	Good	Forest Tree

Total Specimen Trees on This Sheet = 24  
Total Specimen Trees Removed on This Sheet = 14

BALTIMORE COUNTY  
DEPARTMENT OF ENVIRONMENTAL PROTECTION  
AND SUSTAINABILITY  
FOREST CONSERVATION PLAN APPROVAL  
Approved by: *J. G. [Signature]* Date: 8/30/13  
Plan # *FC 13-048*

BALTIMORE COUNTY  
DEPARTMENT OF ENVIRONMENTAL PROTECTION  
AND SUSTAINABILITY  
Forest Buffer Protection Plan Approval  
Approved by: *J. G. [Signature]* Date: 8/30/13  
Plan # *FBP 13-022*

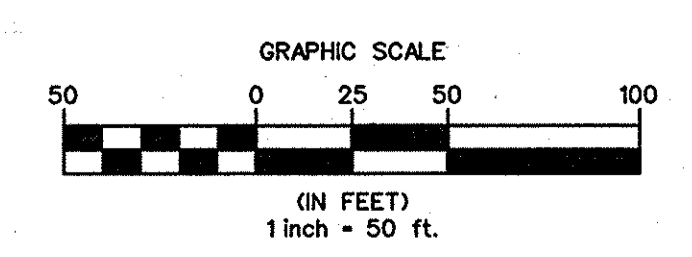

THIS PLAN WAS PREPARED BY:  
JENNIFER BIRD  
KCI TECHNOLOGIES  
MNR QUALIFIED PROFESSIONAL  
STATUS (SEPTEMBER 2011)  
*Jennifer Bird* 08/2013  
SIGNATURE DATE



ENGINEERS  
PLANNERS  
SCIENTISTS  
CONSTRUCTION MANAGERS  
Columbia Gas Transmission, LLC  
A NiSource Company  
936 RINGBROOK ROAD  
SHARPS, MARYLAND 21152  
TELEPHONE: (410) 316-7800  
FAX: (410) 316-7818

NO.	DATE	REVISIONS DESCRIPTION	BY	DATE
				AUGUST 2013

FOREST CONSERVATION PLAN /  
FOREST BUFFER PROTECTION PLAN  
FOR  
COLUMBIA GAS TRANSMISSION, LLC  
LINE MB EXTENSION PROJECT  
PHASE 1  
BALTIMORE COUNTY, MARYLAND

DRAWING NO.  
**FCP-53**  
SHEET 6 OF 15  
KCI JOB NUMBER  
16-121849

PLOTTED: 02:18 PM on Thursday, August 01, 2013  
BY: Amanda Wegener, Division: F050, NetUser: Emp  
FILE: MK2012.16.121849.dwg; PLOT: PLN\_555\_P1A5E-1.dgn

TOTAL FOREST CLEARING WITHIN BC FCE / FBE: 0.00 AC.  
TOTAL FOREST CLEARING WITHIN FB: 0.00 AC.  
TOTAL FOREST CLEARING OUTSIDE FCE / FBE / FB: 1.89 AC.  
TOTAL AREA REPLANTED ON-SITE: 0.00 AC.  
TOTAL AREA REQUIRING OFF-SITE MITIGATION: 1.89 AC.

MATCH LINE - SEE SHEET FCP-56

FOREST STAND 'FFF'  
TULIP POPLAR - NORTHERN RED OAK  
PRIORITY 2: MODERATE  
83,602 SF./1.92 AC.

FOREST STAND 'MM'  
RED MAPLE - VIRGINIA PINE  
PRIORITY 2: MODERATE  
26,607 SF./0.61 AC.

±0.56 ACRES  
FOREST  
CLEARING  
OUTSIDE FCE /  
FBE / FB

FOREST STAND 'EEE'  
TULIP POPLAR  
PRIORITY 2: MODERATE  
42,315 SF./0.97 AC.

±0.01 ACRES  
FOREST  
CLEARING  
OUTSIDE FCE /  
FBE / FB

MATCH LINE - SEE SHEET FCP-53

MATCH LINE - SEE SHEET FCP-55

Number	Species	Common Name	Size DBH (in)	Condition	Notes
SP-834	Liriodendron tulipifera	Tulip Poplar	35.0	Good	Landscape Tree, To Be Removed
SP-835	Liriodendron tulipifera	Tulip Poplar	63.0	Good	Forest Tree
SP-836	Liriodendron tulipifera	Tulip Poplar	37.0	Good	Forest Tree
SP-837	Liriodendron tulipifera	Tulip Poplar	36.0	Good	Forest Tree
SP-838	Liriodendron tulipifera	Tulip Poplar	42.0	Good	Forest Tree
SP-839	Liriodendron tulipifera	Tulip Poplar	42.0	Good	Forest Tree, To Be Removed
SP-840	Liriodendron tulipifera	Tulip Poplar	30.0	Good	Forest Tree
SP-841	Liriodendron tulipifera	Tulip Poplar	33.0	Good	Forest Tree, To Be Removed
SP-842	Liriodendron tulipifera	Tulip Poplar	42.0	Good	Forest Tree
SP-843	Acer rubrum	Red Maple	31.0	Good	Forest Tree
SP-844	Liriodendron tulipifera	Tulip Poplar	34.0	Good	Forest Tree
SP-1756	Liriodendron tulipifera	Tulip Poplar	30.0	Fair	Forest Tree
SP-1757	Liriodendron tulipifera	Tulip Poplar	37.0	Fair	Forest Tree
SP-1758	Liriodendron tulipifera	Tulip Poplar	33.0	Fair	Forest Tree
SP-1759	Liriodendron tulipifera	Tulip Poplar	31.0	Good	Forest Tree
SP-1760	Liriodendron tulipifera	Tulip Poplar	30.0	Good	Landscape Tree
SP-1761	Quercus rubra	Northern Red Oak	34.0	Good	Forest Tree, To Be Removed
SP-1762	Quercus rubra	Northern Red Oak	32.0	Good	Forest Tree, To Be Removed
SP-1763	Quercus rubra	Northern Red Oak	30.0	Good	Forest Tree, To Be Removed
SP-1764	Liriodendron tulipifera	Tulip Poplar	32.0	Good	Forest Tree
SP-1800	Pinus strobus	American Spruce	36.0	Good	Forest Tree
SP-1801	Quercus rubra	Northern Red Oak	39.0	Good	Forest Tree
SP-1802	Quercus rubra	Northern Red Oak	47.0	Good	Landscape Tree
SP-1803	Quercus rubra	Northern Red Oak	32.0	Good	Landscape Tree
SP-1804	Quercus rubra	Northern Red Oak	30.0	Good	Landscape Tree
SP-1805	Liriodendron tulipifera	Tulip Poplar	41.0	Good	Forest Tree
SP-1806	Quercus rubra	Northern Red Oak	34.0	Good	Forest Tree
SP-1807	Liriodendron tulipifera	Tulip Poplar	33.0	Good	Landscape Tree
Total Specimen Trees on This Sheet = 28					
Total Specimen Trees Removed on This Sheet = 6					

BALTIMORE COUNTY  
DEPARTMENT OF ENVIRONMENTAL PROTECTION  
AND SUSTAINABILITY  
FOREST CONSERVATION PLAN APPROVAL  
Approved by: *[Signature]* Date: 8/30/13  
Forest Buffer Protection Plan # FCP 13-026

BALTIMORE COUNTY  
DEPARTMENT OF ENVIRONMENTAL PROTECTION  
AND SUSTAINABILITY  
Forest Buffer Protection Plan Approval  
Approved by: *[Signature]* Date: 8/30/13  
Forest Buffer Protection Plan # FCP 13-026

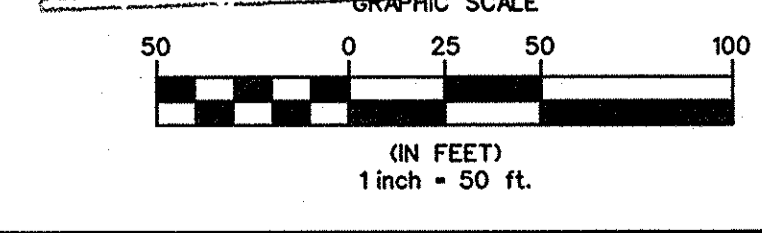

THIS PLAN WAS PREPARED BY:  
JENNIFER BIRD  
KCI TECHNOLOGIES  
MDNR QUALIFIED PROFESSIONAL  
STATUS (SEPTEMBER 2010)  
*[Signature]* 08/2013  
SIGNATURE DATE

ENGINEERS  
PLANNERS  
SCIENTISTS  
CONSTRUCTION MANAGERS

**KCI TECHNOLOGIES**

936 RIDGEBROOK ROAD  
SPRINGFIELD, MARYLAND 21152  
TELEPHONE: (410) 316-7800  
FAX: (410) 316-7818

**Columbia Gas Transmission**  
A NiSource Company

REVISIONS		DATE
NO.	DESCRIPTION	BY

DATE: AUGUST 2013  
SCALE: 1" = 50'  
DESIGNED BY: JB  
DRAWN BY: CSD

FOREST CONSERVATION PLAN /  
FOREST BUFFER PROTECTION PLAN  
FOR  
COLUMBIA GAS TRANSMISSION, LLC  
LINE MB EXTENSION PROJECT  
PHASE 1  
BALTIMORE COUNTY, MARYLAND

DRAWING NO.  
**FCP-54**  
SHEET 7 OF 15  
KCI JOB NUMBER  
16-121849

TOTAL FOREST CLEARING WITHIN BC FCE /FBE: 0.00 AC.  
TOTAL FOREST CLEARING WITHIN FB: 0.00 AC.  
TOTAL FOREST CLEARING OUTSIDE FCE /FBE /FB: 0.57 AC.  
TOTAL AREA REPLANTED ON-SITE: 0.00 AC.  
TOTAL AREA REQUIRING OFF-SITE MITIGATION: 0.57 AC.

MATCH LINE - SEE SHEET FCP-57

MATCH LINE - SEE SHEET FCP-56

MATCH LINE - SEE SHEET FCP-54

MATCH LINE - SEE SHEET FCP-58

FOREST STAND 'YY'  
TULIP POPLAR - RED MAPLE  
PRIORITY 3: LOW  
3,858 SF./0.09 AC.

±0.16 ACRES  
FOREST  
CLEARING  
OUTSIDE FCE /  
FBE /FB

FOREST STAND 'OO'  
BLACK CHERRY - BLACK LOCUST -  
BLACK WALNUT  
PRIORITY 4: DISTURBED  
4,305 SF./0.10 AC.

TOTAL FOREST CLEARING WITHIN BC FCE /FBE: 0.00 AC.  
TOTAL FOREST CLEARING WITHIN FB: 0.00 AC.  
TOTAL FOREST CLEARING OUTSIDE FCE /FBE /FB: 0.16 AC.  
TOTAL AREA REPLANTED ON-SITE: 0.00 AC.  
TOTAL AREA REQUIRING OFF-SITE MITIGATION: 0.16 AC.

BALTIMORE COUNTY  
DEPARTMENT OF ENVIRONMENTAL PROTECTION  
AND SUSTAINABILITY  
FOREST CONSERVATION PLAN APPROVAL  
Approved by: [Signature] Date: 8/30/13  
Reference to Project Review  
MD approved qualified professional  
FOREST CONSERVATION PLAN # EC 13-026

BALTIMORE COUNTY  
DEPARTMENT OF ENVIRONMENTAL PROTECTION  
AND SUSTAINABILITY  
FOREST BUFFER PROTECTION PLAN APPROVAL  
Approved by: [Signature] Date: 8/30/13  
Environmental Impact Review  
Forest Buffer Protection Plan # FBP 13-026

Number	Species	Common Name	Size, DBH (in)	Condition	Notes
SP-885	<i>Prunus serotina</i>	Black Cherry	34.0	Fair	Forest Tree
SP-1343	<i>Acer saccharum</i>	Silver Maple	54.0	Fair	Landscape Tree
SP-1344	<i>Pinus strobus</i>	White Pine	30.0	Good	Landscape Tree

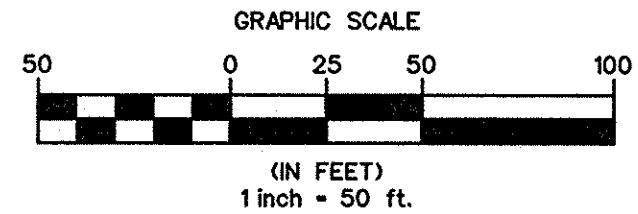

THIS PLAN WAS PREPARED BY:  
JENNIFER BIRD  
KCI TECHNOLOGIES  
MDNR QUALIFIED PROFESSIONAL  
STATUS (SEPTEMBER 2011)  
[Signature] 08/2013  
SIGNATURE DATE

**KCI TECHNOLOGIES**  
ENGINEERS  
PLANNERS  
SCIENTISTS  
CONSTRUCTION MANAGERS  
936 RIDGEBROOK ROAD  
SPARKS, MARYLAND 21152  
TELEPHONE: (410) 316-7800  
FAX: (410) 316-7818

**Columbia Gas Transmission, LLC**  
A NiSource Company

REVISIONS			
NO.	DATE	DESCRIPTION	BY

DATE: AUGUST 2013  
SCALE: 1" = 50'  
DESIGNED BY: JB  
DRAWN BY: CSD

FOREST CONSERVATION PLAN /  
FOREST BUFFER PROTECTION PLAN  
FOR  
COLUMBIA GAS TRANSMISSION, LLC  
LINE MB EXTENSION PROJECT  
PHASE 1  
BALTIMORE COUNTY, MARYLAND

DRAWING NO. **FCP-55**  
SHEET 8 OF 15  
KCI JOB NUMBER  
16-121849

PLOTTED: 10:217 PM on Thursday, August 01, 2013  
BY: Amanda Wegener Division: P&S Natural Resources  
FILE: M:\2013\Projects\FCP-55\Phase-1.dgn



Specimen Tree Details						
Number	Species	Common Name	Size, DBH (in)	Condition	Notes	
SP-1765	Quercus coccinea	Scarlet Oak	48.0	Fair	Forest Tree	
SP-1766	Quercus rubra	Northern Red Oak	40.0	Poor	Forest Tree	To Be Removed
SP-1767	Liriodendron tulipifera	Tulip Poplar	33.0	Fair	Forest Tree	To Be Removed
SP-1768	Liriodendron tulipifera	Tulip Poplar	32.0	Good	Forest Tree	
SP-1769	Liriodendron tulipifera	Tulip Poplar	39.0	Fair	Forest Tree	
SP-1770	Liriodendron tulipifera	Tulip Poplar	35.0	Good	Forest Tree	To Be Removed
SP-1771	Liriodendron tulipifera	Tulip Poplar	31.0	Good	Forest Tree	To Be Removed
SP-1772	Liriodendron tulipifera	Tulip Poplar	33.0	Fair	Forest Tree	To Be Removed
SP-1773	Liriodendron tulipifera	Tulip Poplar	30.0	Good	Forest Tree	
SP-1774	Liriodendron tulipifera	Tulip Poplar	36.0	Poor	Forest Tree	To Be Removed
SP-1775	Liriodendron tulipifera	Tulip Poplar	38.0	Good	Forest Tree	
SP-1776	Quercus rubra	Northern Red Oak	44.0	Fair	Forest Tree	To Be Removed
SP-1777	Liriodendron tulipifera	Tulip Poplar	46.0	Fair	Forest Tree	To Be Removed
SP-1778	Liriodendron tulipifera	Tulip Poplar	34.0	Fair	Forest Tree	To Be Removed
SP-1779	Liriodendron tulipifera	Tulip Poplar	31.0	Good	Forest Tree	
SP-1780	Liriodendron tulipifera	Tulip Poplar	30.0	Good	Forest Tree	
SP-1783	Quercus coccinea	Scarlet Oak	34.0	Good	Forest Tree	
SP-1784	Quercus rubra	Northern Red Oak	36.0	Good	Forest Tree	
SP-1785	Quercus coccinea	Scarlet Oak	33.0	Good	Forest Tree	To Be Removed
SP-1786	Quercus rubra	Northern Red Oak	38.0	Good	Forest Tree	To Be Removed
SP-1787	Quercus rubra	Northern Red Oak	38.0	Fair	Forest Tree	To Be Removed
SP-1808	Liriodendron tulipifera	Tulip Poplar	36.0	Good	Forest Tree	To Be Removed
SP-1809	Fragus grandifolia	American Beech	48.0	Fair	Landscape Tree	
SP-1810	Quercus alba	White Oak	32.0	Fair	Forest Tree	
SP-1811	Carya species	Hickory	30.0	Fair	Forest Tree	To Be Removed
SP-1812	Liriodendron tulipifera	Tulip Poplar	31.0	Good	Forest Tree	To Be Removed
SP-1813	Quercus rubra	Northern Red Oak	37.0	Good	Forest Tree	
SP-1814	Liriodendron tulipifera	Tulip Poplar	32.0	Good	Forest Tree	To Be Removed
SP-1815	Liriodendron tulipifera	Tulip Poplar	31.0	Good	Forest Tree	
SP-1816	Liriodendron tulipifera	Tulip Poplar	31.0	Good	Forest Tree	To Be Removed
SP-1817	Liriodendron tulipifera	Tulip Poplar	37.0	Good	Forest Tree	
SP-1818	Quercus rubra	Northern Red Oak	33.0	Good	Forest Tree	
SP-1820	Liriodendron tulipifera	Tulip Poplar	36.0	Poor	Forest Tree	To Be Removed
SP-1821	Liriodendron tulipifera	Tulip Poplar	38.0	Good	Forest Tree	
SP-1822	Liriodendron tulipifera	Tulip Poplar	42.0	Fair	Forest Tree	
SP-1823	Quercus alba	White Oak	40.0	Fair	Forest Tree	
SP-1824	Liriodendron tulipifera	Tulip Poplar	36.0	Fair	Forest Tree	
SP-1825	Quercus rubra	Northern Red Oak	41.0	Fair	Forest Tree	
SP-1826	Quercus alba	White Oak	31.0	Good	Forest Tree	To Be Removed
SP-1827	Quercus rubra	Northern Red Oak	36.0	Good	Forest Tree	To Be Removed
SP-1828	Quercus alba	White Oak	32.0	Good	Forest Tree	To Be Removed
SP-1829	Quercus rubra	Northern Red Oak	33.0	Good	Forest Tree	To Be Removed
SP-1830	Quercus rubra	Northern Red Oak	38.0	Good	Forest Tree	
SP-1831	Quercus alba	White Oak	31.0	Fair	Forest Tree	To Be Removed
SP-1832	Quercus rubra	Northern Red Oak	37.0	Good	Landscape Tree	
SP-1833	Fraxinus americana	White Ash	34.0	Good	Landscape Tree	
SP-1834	Quercus rubra	Northern Red Oak	40.0	Good	Landscape Tree	
SP-1835	Acer rubrum	Red Maple	39.0	Good	Landscape Tree	
SP-1836	Liriodendron tulipifera	Tulip Poplar	32.0	Fair	Forest Tree	
Total Specimen Trees on This Sheet = 50						
Total Specimen Trees Removed on This Sheet = 21						

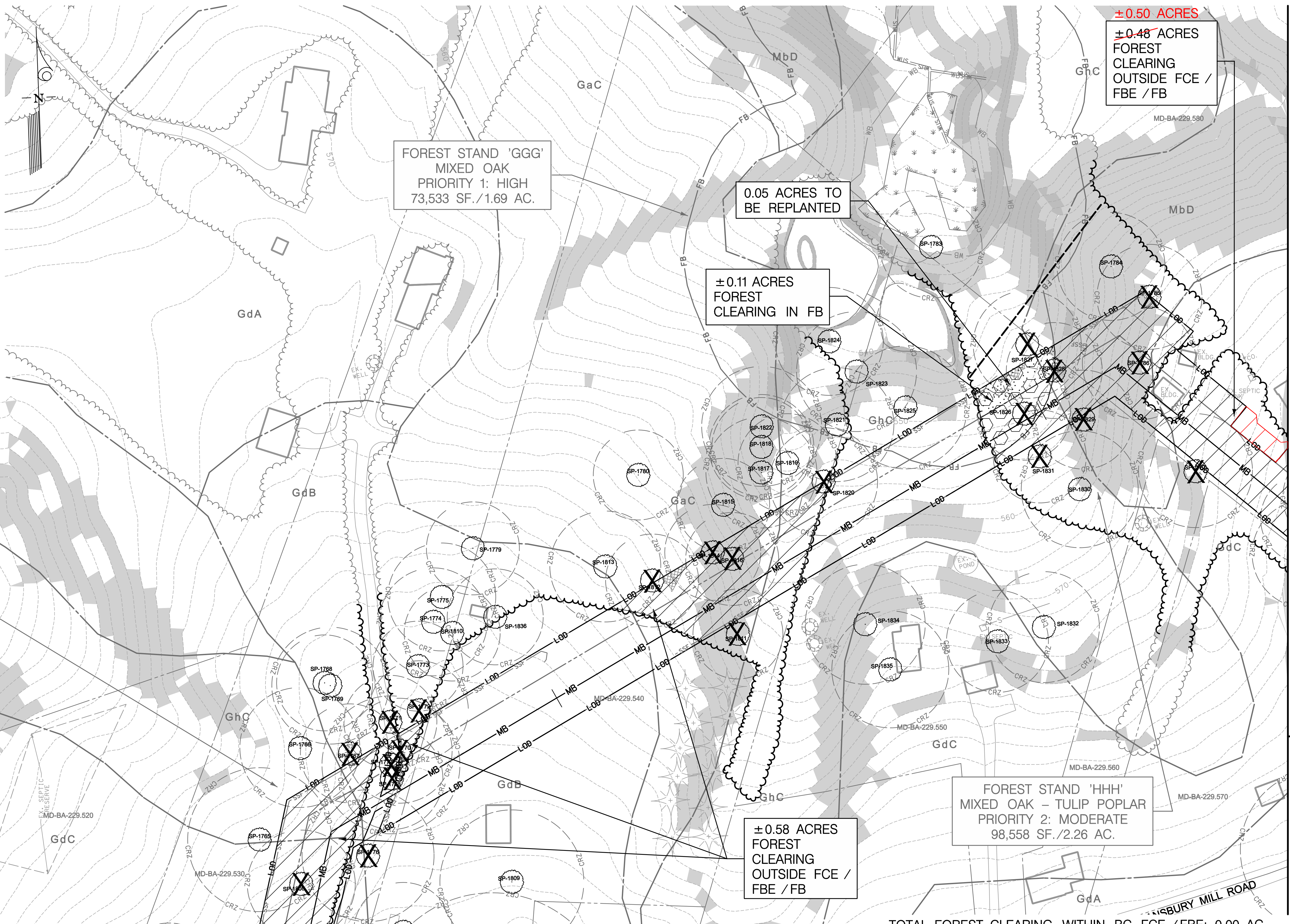

±0.50 ACRES  
±0.48 ACRES  
FOREST  
CLEARING  
OUTSIDE FCE /  
FBE / FB

FOREST STAND 'GGG'  
MIXED OAK  
PRIORITY 1: HIGH  
73,533 SF./1.69 AC.

0.05 ACRES TO  
BE REPLANTED

±0.11 ACRES  
FOREST  
CLEARING IN FB

FOREST STAND 'FFF'  
TULIP POPLAR - NORTHERN RED OAK  
PRIORITY 2: MODERATE  
83,602 SF./1.92 AC.

FOREST STAND 'HHH'  
MIXED OAK - TULIP POPLAR  
PRIORITY 2: MODERATE  
98,558 SF./2.26 AC.

±0.58 ACRES  
FOREST  
CLEARING  
OUTSIDE FCE /  
FBE / FB

TOTAL FOREST CLEARING WITHIN BC FCE /FBE: 0.00 AC.  
TOTAL FOREST CLEARING WITHIN FB: 0.11 AC.  
TOTAL FOREST CLEARING OUTSIDE FCE /FBE /FB: ~~1.06 AC~~ 1.08 AC.  
TOTAL AREA REPLANTED ON-SITE: 0.05 AC.  
TOTAL AREA REQUIRING OFF-SITE MITIGATION: ~~1.12 AC~~ 1.14 AC.

PLOTTED: 01:46 PM on Wednesday, May 14, 2014  
FILE: M:\2012\161218429\Drawings\FCP\PLAN\_55\_PHASE-1\_Redlined.dwg

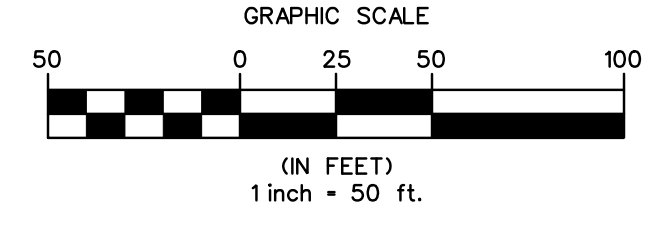

THIS PLAN WAS PREPARED BY:  
JENNIFER BIRD  
KCI TECHNOLOGIES  
MDNR QUALIFIED PROFESSIONAL  
STATUS (SEPTEMBER 2011)  
*Jennifer Bird*  
SIGNATURE 08/2013  
DATE

**KCI TECHNOLOGIES**  
ENGINEERS  
PLANNERS  
SCIENTISTS  
CONSTRUCTION MANAGERS  
936 RIDGEBROOK ROAD  
SPARKS, MARYLAND 21152  
TELEPHONE: (410) 316-7800  
FAX: (410) 316-7818

**Columbia Gas Transmission**  
A NiSource Company

REVISIONS			
NO.	DATE	DESCRIPTION	BY
1	MAY 2014	LIMIT OF DISTURBANCE AND TREE REMOVAL EXPANDED	CSD

DATE AUGUST 2013  
SCALE 1" = 50'  
DESIGNED BY JB  
DRAWN BY CSD

FOREST CONSERVATION PLAN /  
FOREST BUFFER PROTECTION PLAN  
FOR  
COLUMBIA GAS TRANSMISSION, LLC  
LINE MB EXTENSION PROJECT  
PHASE 1  
BALTIMORE COUNTY, MARYLAND

DRAWING NO.  
**FCP-56**  
SHEET 9 OF 15  
KCI JOB NUMBER  
16-121849

MATCH LINE - SEE SHEET FCP-57

MATCH LINE - SEE SHEET FCP-55

MATCH LINE - SEE SHEET FCP-54

Number	Species	Common Name	Size DBH (in)	Condition	Notes
SP-1346	Acer platanoides	Norway Maple	34.0	Good	Landscape Tree
SP-1347	Acer rubrum	Red Maple	33.0	Good	Landscape Tree
SP-1348	Pinus strobus	White Pine	35.0	Good	Landscape Tree
SP-1349	Acer saccharinum	Silver Maple	39.0	Good	Landscape Tree
SP-1350	Liriodendron tulipifera	Tulip Poplar	47.0	Fair	Landscape Tree, To Be Removed
SP-1351	Acer saccharinum	Silver Maple	38.0	Good	Landscape/Street Tree
SP-1352	Acer saccharinum	Silver Maple	42.0	Good	Landscape Tree
SP-1353	Acer saccharinum	Silver Maple	39.0	Good	Landscape Tree
SP-1354	Acer saccharinum	Silver Maple	34.0	Good	Landscape Tree
SP-1355	Liriodendron tulipifera	Tulip Poplar	31.0	Poor	Landscape/Street Tree
SP-1356	Liriodendron tulipifera	Tulip Poplar	33.0	Poor	Landscape/Street Tree
SP-1357	Liriodendron tulipifera	Tulip Poplar	30.0	Poor	Landscape/Street Tree
SP-1358	Quercus rubra	Northern Red Oak	35.0	Poor	Landscape/Street Tree
SP-1359	Quercus rubra	Northern Red Oak	43.0	Poor	Landscape/Street Tree
SP-1360	Liriodendron tulipifera	Tulip Poplar	31.0	Good	Forest Tree, To Be Removed
SP-1361	Prunus serotina	Black Cherry	49.0	Fair	Forest Tree, To Be Removed
SP-1658	Acer platanoides	Norway Maple	42.0	Good	Landscape Tree, To Be Removed
SP-1659	Acer platanoides	Norway Maple	33.0	Good	Landscape Tree, To Be Removed
SP-1660	Liriodendron tulipifera	Tulip Poplar	30.0	Fair	Hedge-row Tree
SP-1661	Liriodendron tulipifera	Tulip Poplar	30.0	Good	Hedge-row Tree
SP-1662	Liriodendron tulipifera	Tulip Poplar	53.0	Fair	Hedge-row Tree
SP-1663	Liriodendron tulipifera	Tulip Poplar	32.0	Good	Hedge-row Tree
SP-1753	Acer platanoides	Norway Maple	30.0	Good	Landscape Tree, To Be Removed
SP-1758	Liriodendron tulipifera	Tulip Poplar	30.0	Good	Forest Tree, To Be Removed
SP-1789	Quercus rubra	Northern Red Oak	34.0	Good	Forest Tree, To Be Removed
SP-1790	Quercus rubra	Northern Red Oak	36.0	Good	Forest Tree, To Be Removed
SP-1791	Liriodendron tulipifera	Tulip Poplar	32.0	Good	Forest Tree, To Be Removed
SP-1792	Acer rubrum	Red Maple	46.0	Fair	Forest Tree, To Be Removed
SP-1793	Fagus grandifolia	American Beech	35.0	Good	Forest Tree

Total Specimen Trees on This Sheet = 29  
Total Specimen Trees Removed on This Sheet = 11

FOREST STAND 'ZZ'  
TULIP POPLAR - SASSAFRAS  
PRIORITY 2: MODERATE  
68,852 SF./1.58 AC.

FOREST STAND 'HHH'  
MIXED OAK - TULIP POPLAR  
PRIORITY 2: MODERATE  
98,558 SF./2.26 AC.

±0.30 ACRES  
FOREST  
CLEARING  
OUTSIDE FCE /  
FBE /FB

±0.37 ACRES  
FOREST  
CLEARING  
OUTSIDE FCE /  
FBE /FB

MATCH LINE - SEE SHEET FCP-56

MATCH LINE - SEE SHEET FCP-58

MATCH LINE - SEE SHEET FCP-55

TOTAL FOREST CLEARING WITHIN BC FCE /FBE: 0.00 AC.  
TOTAL FOREST CLEARING WITHIN FB: 0.00 AC.  
TOTAL FOREST CLEARING OUTSIDE FCE /FBE /FB: 0.67 AC.  
TOTAL AREA REPLANTED ON-SITE: 0.00 AC.  
TOTAL AREA REQUIRING OFF-SITE MITIGATION: 0.67 AC.

PLOTTED: 02:18 PM on Thursday, August 01, 2013  
BY: Amanda Wegener, Division: P&S, Natural Resources  
FILE: M:\2013\2152\GIS\Drawings\FCP\AN\_57\_1\_P1\FCP-57.dgn

BALTIMORE COUNTY  
DEPARTMENT OF ENVIRONMENTAL PROTECTION  
AND SUSTAINABILITY  
FOREST CONSERVATION PLAN APPROVAL  
Approved by: *J. G. Russo* Date: 8/13/13  
Professional Engineer  
Forest Conservation Plan # FCP-57-046

BALTIMORE COUNTY  
DEPARTMENT OF ENVIRONMENTAL PROTECTION  
AND SUSTAINABILITY  
Forest Buffer Protection Plan Approval  
Approved by: *J. G. Russo* Date: 8/13/13  
Environmental Impact Advisor  
Forest Buffer Protection Plan #FBP-13-026

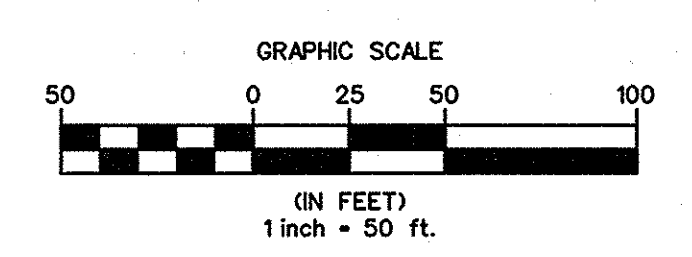

THIS PLAN WAS PREPARED BY:  
JENNIFER BIRD  
KCI TECHNOLOGIES  
MDNR QUALIFIED PROFESSIONAL  
STATUS (SEPTEMBER 2011)  
*Jennifer H. Bird* 08/2013  
SIGNATURE DATE

ENGINEERS  
PLANNERS  
SCIENTISTS  
CONSTRUCTION MANAGERS  
**KCI**  
TECHNOLOGIES  
936 RIDGEBROOK ROAD  
SHARPS, MARYLAND 21152  
TELEPHONE: (410) 316-7800  
FAX: (410) 316-7818

**Columbia Gas Transmission**  
A NiSource Company

NO.		DATE		REVISIONS	DESCRIPTION	BY

DATE  
AUGUST 2013  
SCALE  
1" = 50'  
DESIGNED BY  
JB  
DRAWN BY  
CSD

FOREST CONSERVATION PLAN /  
FOREST BUFFER PROTECTION PLAN  
FOR  
COLUMBIA GAS TRANSMISSION, LLC  
LINE MB EXTENSION PROJECT  
PHASE 1  
BALTIMORE COUNTY, MARYLAND

DRAWING NO.  
**FCP-57**  
SHEET 10 OF 15  
KCI JOB NUMBER  
16-121849

MATCH LINE - SEE SHEET FCP-55

MATCH LINE - SEE SHEET FCP-57

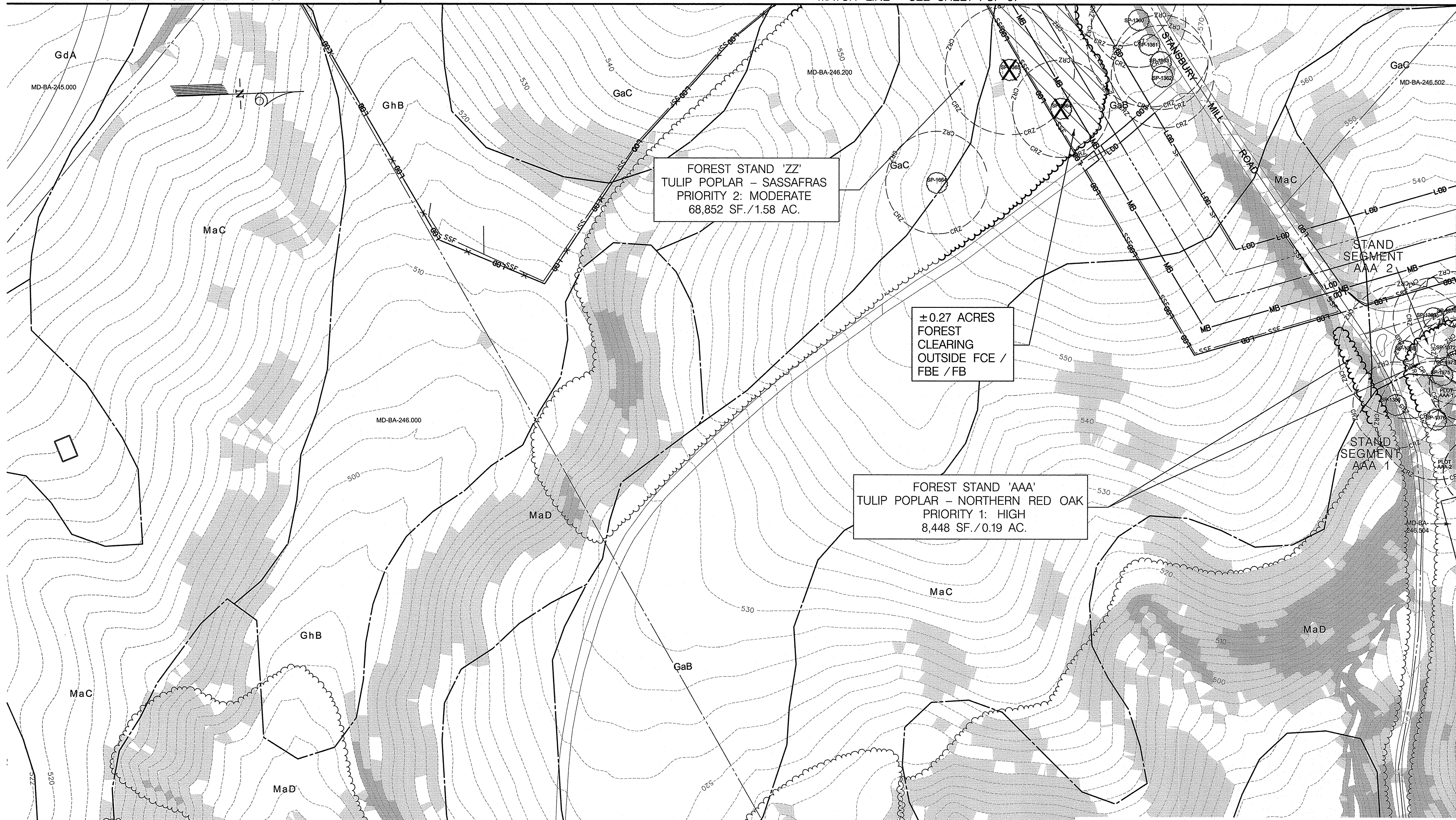

FOREST STAND 'ZZ'  
TULIP POPLAR - SASSAFRAS  
PRIORITY 2: MODERATE  
68,852 SF./1.58 AC.

±0.27 ACRES  
FOREST  
CLEARING  
OUTSIDE FCE /  
FBE / FB

FOREST STAND 'AAA'  
TULIP POPLAR - NORTHERN RED OAK  
PRIORITY 1: HIGH  
8,448 SF./0.19 AC.

STAND  
SEGMENT  
AAA 2

STAND  
SEGMENT  
AAA 1

TOTAL FOREST CLEARING WITHIN BC FCE / FBE: 0.00 AC.  
TOTAL FOREST CLEARING WITHIN FB: 0.00 AC.  
TOTAL FOREST CLEARING OUTSIDE FCE / FBE / FB: 0.27 AC.  
TOTAL AREA REPLANTED ON-SITE: 0.00 AC.  
TOTAL AREA REQUIRING OFF-SITE MITIGATION: 0.27 AC.

Specimen Tree Details						
Number	Species	Common Name	Size, DBH (in)	Condition	Notes	
SP-1360	Myrica sylvatica	Black Gum	35.0	Good	Landscape/Street Tree	
SP-1361	Liriodendron tulipifera	Tulip Poplar	46.0	Fair	Landscape/Street Tree	
SP-1362	Liriodendron tulipifera	Tulip Poplar	38.0	Good	Landscape/Street Tree	
SP-1363	Liriodendron tulipifera	Tulip Poplar	35.0	Good	Landscape/Street Tree	
SP-1364	Liriodendron tulipifera	Tulip Poplar	36.0	Fair	Forest Tree, To Be Removed	
SP-1365	Quercus rubra	Northern Red Oak	46.0	Fair	Forest Tree, To Be Removed	
SP-1368	Quercus alba	White Oak	50.0	Fair	Forest Tree	
SP-1369	Quercus alba	White Oak	30.0	Good	Forest Tree	
SP-1370	Quercus rubra	Northern Red Oak	33.0	Fair	Forest Tree	
SP-1372	Liriodendron tulipifera	Tulip Poplar	30.0	Good	Forest Tree	
SP-1373	Liriodendron tulipifera	Tulip Poplar	32.0	Poor	Forest Tree	
SP-1375	Liriodendron tulipifera	Tulip Poplar	38.0	Fair	Forest Tree	
SP-1376	Liriodendron tulipifera	Tulip Poplar	44.0	Good	Forest Tree	
SP-1380	Liriodendron tulipifera	Tulip Poplar	32.0	Good	Forest Tree	
SP-1664	Liriodendron tulipifera	Tulip Poplar	38.0	Poor	Forest Tree	
Total Specimen Trees on This Sheet = 15						
Total Specimen Trees Removed on This Sheet = 2						

BALTIMORE COUNTY  
DEPARTMENT OF ENVIRONMENTAL PROTECTION  
AND SUSTAINABILITY  
FOREST CONSERVATION PLAN APPROVAL  
*John A. Brown* Date: 8/20/13  
Approved by: *John A. Brown* Date: 8/20/13  
Professional Engineer  
FOREST CONSERVATION PLAN # FC 13-046

BALTIMORE COUNTY  
DEPARTMENT OF ENVIRONMENTAL PROTECTION  
AND SUSTAINABILITY  
Forest Buffer Protection Plan Approval  
Approved by: *John A. Brown* Date: 8/20/13  
Professional Engineer  
Forest Buffer Protection Plan # FAP 13-036

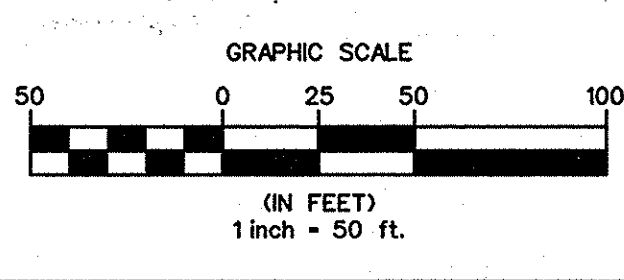

THIS PLAN WAS PREPARED BY:  
JENNIFER BIRD  
KCI TECHNOLOGIES  
MDNR QUALIFIED PROFESSIONAL  
STATUS (SEPTEMBER 2011)  
*Jennifer Bird* 08/2013  
SIGNATURE DATE

ENGINEERS  
PLANNERS  
SCIENTISTS  
CONSTRUCTION MANAGERS

**KCI**  
TECHNOLOGIES

936 RIDGEBOOM ROAD  
SHARPS, MARYLAND 21152  
TELEPHONE: (410) 316-7800  
FAX: (410) 316-7818

**Columbia Gas**  
Transmission, LLC  
A NiSource Company

REVISIONS		DATE
NO.	DATE	DESCRIPTION

DATE: AUGUST 2013  
SCALE: 1" = 50'  
DESIGNED BY: JB  
DRAWN BY: CSD

FOREST CONSERVATION PLAN /  
FOREST BUFFER PROTECTION PLAN  
FOR  
COLUMBIA GAS TRANSMISSION, LLC  
LINE MB EXTENSION PROJECT  
PHASE 1  
BALTIMORE COUNTY, MARYLAND

DRAWING NO.  
**FCP-58**  
SHEET 11 OF 15  
KCI JOB NUMBER  
16-121849

PLOTTED: 02:18 PM on Thursday, August 01, 2013  
BY: Amanda Wagoner, Division: FCSI, NetUser: Emp  
FILE: M:\2012\1621849\Drawings\FCP\_Plan\_S5\_P1-58-Phase-1.dgn

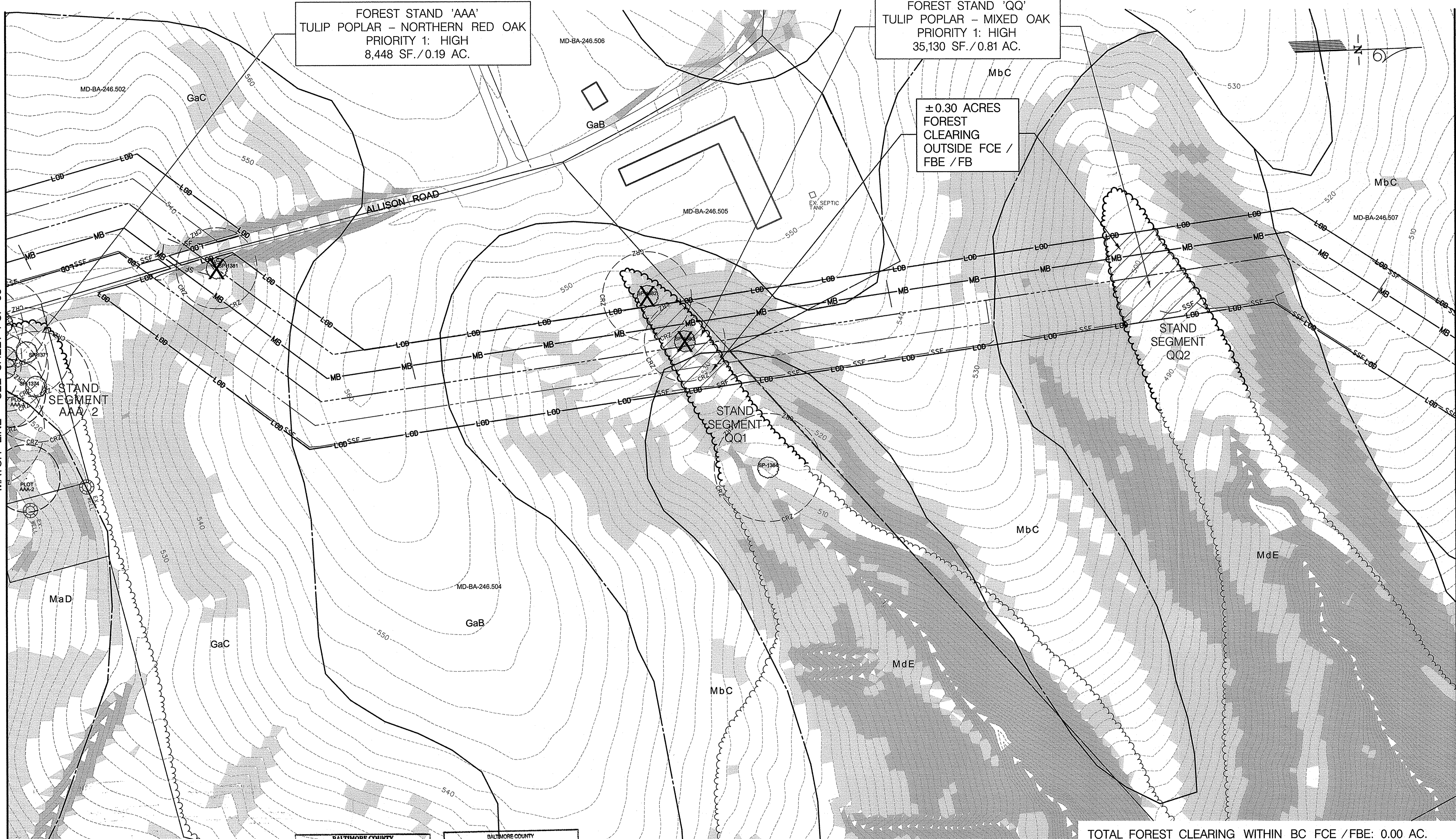

FOREST STAND 'AAA'  
TULIP POPLAR - NORTHERN RED OAK  
PRIORITY 1: HIGH  
8,448 SF./0.19 AC.

FOREST STAND 'QQ'  
TULIP POPLAR - MIXED OAK  
PRIORITY 1: HIGH  
35,130 SF./0.81 AC.

±0.30 ACRES  
FOREST  
CLEARING  
OUTSIDE FCE /  
FBE /FB

MATCH LINE - SEE SHEET FCP-58

MATCH LINE - SEE SHEET FCP-60

BALTIMORE COUNTY  
DEPARTMENT OF ENVIRONMENTAL PROTECTION  
AND SUSTAINABILITY  
FOREST CONSERVATION PLAN APPROVAL  
Approved by: *[Signature]* Date: 8/30/12  
NRE approved professional  
FOREST CONSERVATION PLAN # **FCP-13-046**

BALTIMORE COUNTY  
DEPARTMENT OF ENVIRONMENTAL PROTECTION  
AND SUSTAINABILITY  
Forest Buffer Protection Plan Approval  
Approved by: *[Signature]* Date: 8/30/13  
NRE approved professional  
Forest Buffer Protection Plan # **FBP-13-024**

TOTAL FOREST CLEARING WITHIN BC FCE /FBE: 0.00 AC.  
TOTAL FOREST CLEARING WITHIN FB: 0.00 AC.  
TOTAL FOREST CLEARING OUTSIDE FCE /FBE /FB: 0.30 AC.  
TOTAL AREA REPLANTED ON-SITE: 0.00 AC.  
TOTAL AREA REQUIRING OFF-SITE MITIGATION: 0.30 AC.

Number	Species	Common Name	Size, DBH (in)	Condition	Notes
SP-1374	Liriodendron tulipifera	Tulip Poplar	33.0	Good	Forest Tree
SP-1374	Liriodendron tulipifera	Tulip Poplar	41.0	Fair	Forest Tree
SP-1381	Liriodendron tulipifera	Tulip Poplar	30.0	Fair	Street Tree, To Be Removed
SP-1382	Robinia pseudoacacia	Black Locust	33.0	Poor	Forest Tree, To Be Removed
SP-1383	Robinia pseudoacacia	Black Locust	30.0	Fair	Forest Tree, To Be Removed
SP-1384	Fraxinus americana	White Ash	42.0	Fair	Forest Tree
Total Specimen Trees on This Sheet = 6					
Total Specimen Trees Removed on This Sheet = 3					

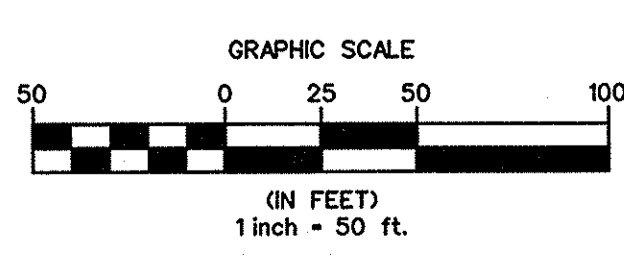

THIS PLAN WAS PREPARED BY:  
JENNIFER BIRD  
KCI TECHNOLOGIES  
MONITOR QUALIFIED PROFESSIONAL  
STATUS (SEPTEMBER 2011)  
*[Signature]* 08/2013  
SIGNATURE DATE

**KCI TECHNOLOGIES**  
ENGINEERS  
PLANNERS  
SCIENTISTS  
CONSTRUCTION MANAGERS  
936 RIDGEBROOK ROAD  
SWANS, MARYLAND 21152  
TELEPHONE: (410) 316-7800  
FAX: (410) 316-7818

**Columbia Gas Transmission, LLC**  
A NiSource Company

NO.	DATE	REVISIONS DESCRIPTION	BY	DATE
				AUGUST 2013

FOREST CONSERVATION PLAN /  
FOREST BUFFER PROTECTION PLAN  
FOR  
COLUMBIA GAS TRANSMISSION, LLC  
LINE MB EXTENSION PROJECT  
PHASE 1  
BALTIMORE COUNTY, MARYLAND

DRAWING NO.  
**FCP-59**  
SHEET 12 OF 15  
KCI JOB NUMBER  
16-121849

PLOTED: 02:20 PM on Thursday, August 01, 2013  
BY: Amanda Wagoner, Division: P050 Natural Resources  
FILE: M:\2012\16121849\Drawings\FCP-PLAN\_S9\_PHASE-1.dwg

FOREST STAND 'QQ'  
TULIP POPLAR - MIXED OAK  
PRIORITY 1: HIGH  
35,130 SF./0.81 AC.

FOREST STAND 'BBB'  
HONEY LOCUST -  
AMERICAN SYCAMORE  
PRIORITY 1: HIGH  
112,305 SF./2.58 AC.

FOREST STAND 'QQ'  
TULIP POPLAR - MIXED OAK  
PRIORITY 1: HIGH  
35,130 SF./0.81 AC.

BALTIMORE COUNTY  
HARFORD COUNTY

MATCH LINE - SEE SHEET FCP-59

MATCH LINE - SEE SHEET FCP-61

BALTIMORE COUNTY  
DEPARTMENT OF ENVIRONMENTAL PROTECTION  
AND SUSTAINABILITY  
FOREST CONSERVATION PLAN APPROVAL  
Approved by: *[Signature]* 8/30/13  
Environmental Impact Review  
Forest Conservation Plan # **FC 13-046**

BALTIMORE COUNTY  
DEPARTMENT OF ENVIRONMENTAL PROTECTION  
AND SUSTAINABILITY  
Forest Buffer Protection Plan Approval  
Approved by: *[Signature]* 8/30/13  
Environmental Impact Review  
Forest Buffer Protection Plan # **FBP 13-026**

Specimen Tree Details						
Number	Species	Common Name	Size, DBH (in)	Condition	Notes	Jurisdiction
SP-1385	<i>Lupinus nigra</i>	Black Walnut	37.0	Good	Forest Tree	Balt. Co.
SP-1386	<i>Liriodendron tulipifera</i>	Tulip Poplar	36.0	Poor	Forest Tree	Balt. Co.
SP-1387	<i>Platanus occidentalis</i>	Sycamore	42.0	Fair	Forest Tree	Balt. Co.
SP-1388	<i>Platanus occidentalis</i>	Sycamore	36.0	Fair	Forest Tree	Balt. Co.
SP-1389	<i>Platanus occidentalis</i>	Sycamore	38.0	Fair	Forest Tree	Balt. Co.
Total Specimen Trees on This Sheet = 5						
Total Specimen Trees Removed on This Sheet = 0						

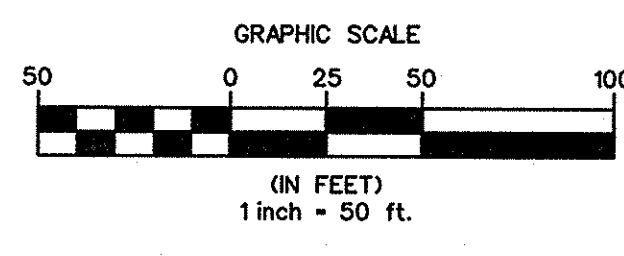

THIS PLAN WAS PREPARED BY:  
JENNIFER BIRD  
KCI TECHNOLOGIES  
MDNR QUALIFIED PROFESSIONAL  
STATUS (SEPTEMBER 2011)  
*[Signature]* 08/2013  
SIGNATURE DATE

**KCI TECHNOLOGIES**  
ENGINEERS  
PLANNERS  
SCIENTISTS  
CONSTRUCTION MANAGERS  
936 RIDGEBROOK ROAD  
SPARKS, MARYLAND 21152  
TELEPHONE: (410) 316-7800  
FAX: (410) 316-7818

**Columbia Gas Transmission**  
A NiSource Company

REVISIONS			
NO.	DATE	DESCRIPTION	BY

DATE AUGUST 2013  
SCALE 1" = 50'  
DESIGNED BY JB  
DRAWN BY CSD

NOTE: NO FOREST STAND IMPACTS ON THIS SHEET

FOREST CONSERVATION PLAN /  
FOREST BUFFER PROTECTION PLAN  
FOR  
COLUMBIA GAS TRANSMISSION, LLC  
LINE MB EXTENSION PROJECT  
PHASE 1  
BALTIMORE COUNTY, MARYLAND

DRAWING NO. **FCP-60**  
SHEET 13 OF 15  
KCI JOB NUMBER 16-121849

PLOTTED: 09/20/13, PM on Thursday, August 01, 2013  
BY: Amanda Wegener, Division: PDD, Nature Resources  
FILE: M:\2012\16121849.dwg, dwg, 16121849.dwg, BALTIMORE COUNTY, PHASE-1.dwg



PLOTTED: 10/21/13 PM on Thursday, August 01, 2013  
 BY: Amanda Weisner, Division: PDSO, NaturalRes\_Emp  
 FILE: M:\2013\162849.dwg

Tract ID	Milepost	Easement Type	Crossing Distance (feet unless otherwise noted)
MD-BA-246.504	17.3 - 17.4	Baltimore County Rural Legacy c	812
MD-BA-246.505	17.4	Baltimore County Rural Legacy c	219
MD-BA-246.507	17.4 - 17.6	Baltimore County Rural Legacy c	1,325

c All Baltimore County Rural Legacy areas crossed by the project are within the state-approved Rural Legacy area under the administrative jurisdiction of the Manor Conservancy, Inc.

NOTE: EASEMENTS CROSSED BY CONSTRUCTION WORK AREA

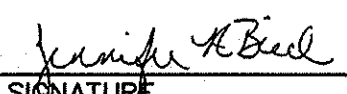
THIS PLAN WAS PREPARED BY:  
 JENNIFER BIRD  
 KCI TECHNOLOGIES  
 MDR QUALIFIED PROFESSIONAL  
 STATUS (SEPTEMBER 2011)  
  
 SIGNATURE

08/2013  
DATE



REVISIONS				DATE
NO.	DATE	DESCRIPTION	BY	AUGUST 2013
				SCALE 1" = 50'
				DESIGNED BY JB
				DRAWN BY CSD

EASEMENT INFORMATION  
 FOR  
 COLUMBIA GAS TRANSMISSION, LLC  
 LINE MB EXTENSION PROJECT  
 PHASE 1  
 BALTIMORE COUNTY, MARYLAND

DRAWING NO.  
**ET-1**  
 SHEET 15 OF 15  
 KCI JOB NUMBER  
 16-121849

## Ripley, Julia/ATL

---

**From:** Glenn Shaffer <gshaffer@baltimorecountymd.gov>  
**Sent:** Tuesday, June 03, 2014 11:44 AM  
**To:** Ripley, Julia/ATL  
**Cc:** Jennifer.Bird@kci.com  
**Subject:** RE: Columbia Gas Line MB Red-lined FCP/FBPP Mylars

Hi Julia,

I didn't stamp/process them, as the change was so small that it didn't matter. I did keep a paper copy of the revised sheets.

The red lined FCP/FBPP with the 0.02 ac of additional forest clearing is approved.

**CHANGE OF ADDRESS  
EFFECTIVE FEB. 4, 2013**

Glenn Shaffer  
Environmental Impact Review  
Baltimore County Environmental Protection & Sustainability  
111 W. Chesapeake Ave, Room 319  
Towson, MD 21204  
PHONE 410-887-3980  
FAX 410-887-4804

>>> <Julia.Ripley@ch2m.com> 06/03/14 11:35 AM >>>

Hi Glenn,

KCI picked up the mylars yesterday, and they noticed that the pages are not stamped or signed. Can you confirm that our set should be unsigned/unstamped? If they aren't supposed to be signed, can you please provide us with a quick note confirming that the redline revisions dated May 2014 are approved?

Thanks,

Julia

Julia Ripley

Direct 678.530.4418  
Mobile [REDACTED]  
Internal Extension 54418

---

**From:** Glenn Shaffer [mailto:gshaffer@baltimorecountymd.gov]  
**Sent:** Monday, June 02, 2014 9:54 AM  
**To:** Jennifer.Bird@kci.com  
**Cc:** Patricia Farr; Ripley, Julia/ATL  
**Subject:** Columbia Gas Line MB Red-lined FCP/FBPP Mylars



Hi Jennifer,

The subject mylars are ready to be picked up at your convenience from our lobby.

The revision to forest clearing was so small (0.02 ac increase) that I didn't have the entire plan set rescanned. Rather, I made copies of only 2 the red-lined sheets and filed them. I already discussed this with Julia last week.

Thanks

**CHANGE OF ADDRESS**

**EFFECTIVE FEB. 4, 2013**

Glenn Shaffer

Environmental Impact Review

Baltimore County Environmental Protection & Sustainability

111 W. Chesapeake Ave, Room 319

Towson, MD 21204

PHONE 410-887-3980

FAX 410-887-4804

**CONNECT WITH BALTIMORE COUNTY**



[www.baltimorecountymd.gov](http://www.baltimorecountymd.gov)

**CONNECT WITH BALTIMORE COUNTY**



[www.baltimorecountymd.gov](http://www.baltimorecountymd.gov)